



Building 9 (Culture Center) Renovations Project

West Virginia Department of Tourism

EXPRESSION OF INTEREST FROM
QUINN EVANS + SILLING
12.04.2025

QUINN
EVANS

SILLING

Contents

1. Cover Letter & Required Forms..... 03

2. Firm Profile & Qualifications..... 07

3. Project Team..... 10

4. Project Approach & Objectives.....29

5. Project Experience 41

6. References.....63

December 4, 2025



Hanna Kroeger
Accounting Coordinator
West Virginia Department of Tourism
Building 3, Suite 100
State Capitol Complex
1900 Kanawha Boulevard, East
Charleston, West Virginia 25305

**RE: Building 9 (Culture Center) Renovations Project
#AEOI TOR2600000003**

Dear Ms. Kroeger and Members of the Selection Committee:

The Quinn Evans + Silling team is pleased to submit our qualifications to provide professional architectural and engineering services for the Building 9 (Culture Center) Renovations Project.

Quinn Evans is a nationally recognized firm in the practice of preserving, optimizing, and renewing the value of existing buildings. We understand the importance of **cultural and sustainable stewardship** when it comes to important iconic buildings such as the Culture Center. Quinn Evans' 2024 AIA Firm Award attests to the importance of our **national expertise on existing buildings and stewardship of existing places**.

Silling, our local architectural partner, is a long-standing West Virginia practice established in Charleston in 1902, and the original Architect of Record for the West Virginia Science and Cultural Center. Silling takes great pride in being one of the longest continuously operating practices in the U.S. and is a studio centered on the core principle of Getting It Right – in design, service, and relationships. Silling is a trusted partner with the State of West Virginia, having worked on hundreds of projects with various State entities over the past 123 years. Quinn Evans and Silling are firms rooted in collaboration, and this unifying foundation, together with our complementary portfolios, creates a team that has the experience to respond to all of the opportunities this project presents.

Together, we form a curated team uniquely positioned to deliver **national expertise and local presence** with a **long history of successful projects in the civic, performing arts, and cultural heritage realms**. The Culture Center Renovations Project presents an opportunity to re-engage with a legacy building on the State Capitol Campus delivered by our team's predecessors in 1976. We are thrilled about the opportunity to assist the Department of Tourism in planning and designing for its next stage of life.

Strong and Responsive Design Team with expertise and experience in revitalizing modern-era buildings:

We have assembled a strong and responsive design team that is able to understand, assess, and analyze the existing building and systems in their entirety, while providing recommendations for improvement that focus on retaining and elevating the historic character of the building. The Culture Center, like many buildings of its era, is not only a cultural and civic icon in Charleston, with its soaring interior public spaces, but is also constructed with materials and systems of its time that can be renewed for much improved performance and durability. Our design team brings years of experience and expertise in this practice, along with a thoughtful design approach that results in renewed and revitalized spaces and places.

Focus on Key Project Goals: Between Quinn Evans, Silling, and our key consultants, we have engaged in hundreds of projects involving comprehensive building assessments that have been translated into effective and targeted projects, ranging from envelope and system repairs to transformative design renewals and complete renovations. Those types of projects often go hand in hand with developing multiple bid packages to assist Owners with the available budgets and project phasing, as well as to accommodate cost-effective strategies for making changes in occupied buildings. Together, we will define the project goals that will create a framework for decision-making and priority setting throughout this effort and future project definition and execution.

Thank you for reviewing our qualifications. We look forward to a future project partnership with you.

Cordially,
Quinn Evans

A black ink signature of Thomas C. Jester.

Thomas C. Jester, FAIA, FAPT, LEED AP
Principal in Charge
thomas.jester@quinnevens.com
202.591.2537

Silling

A black ink signature of Jody Driggs.

Jody Driggs, AIA
Principal
jdriggs@silling.com
304.549.4036

A blue ink signature of Kathryn Slattery.

Kathryn Slattery, AIA, LEED AP
Senior Project Manager
& Primary Point of Contact
kathryn.slattery@quinnevens.com
202.591.2526

4. GREEN BUILDINGS MINIMUM ENERGY STANDARDS: In accordance with West Virginia Code § 22-29-4, all new building construction projects of public agencies that have not entered the schematic design phase prior to July 1, 2012, or any building construction project receiving state grant funds and appropriations, including public schools, that have not entered the schematic design phase prior to July 1, 2012, shall be designed and constructed complying with the ICC International Energy Conservation Code, adopted by the State Fire Commission, and the ANSI/ASHRAE/IESNA Standard 90.1-2007: Provided, That if any construction project has a commitment of federal funds to pay for a portion of such project, this provision shall only apply to the extent such standards are consistent with the federal standards.

DESIGNATED CONTACT: Vendor appoints the individual identified in this Section as the Contract Administrator and the initial point of contact for matters relating to this Contract.

Kathryn Slattery, AIA, LEED AP	Principal		
Name	Title		
kathryn.slattery@quinnevens.com	202.591.2526		
Email	Phone Number		
2101 L Street NW, Suite 950	DC	20037	
Address	City	State	Zip

CERTIFICATION AND SIGNATURE: By signing below, I certify that: I have reviewed this Solicitation in its entirety; that I understand the requirements, terms and conditions, and other information contained herein; that this bid, offer or proposal constitutes an offer to the State that cannot be unilaterally withdrawn; that the product or service proposed meets the mandatory requirements contained in the Solicitation for that product or service, unless otherwise stated herein; that the Vendor accepts the terms and conditions contained in the Solicitation, unless otherwise stated herein; that I am submitting this bid, offer or proposal for review and consideration; that I am authorized by the vendor to execute and submit this bid, offer, or proposal, or any documents related thereto on vendor's behalf; that I am authorized to bind the vendor in a contractual relationship; and that to the best of my knowledge, the vendor has properly registered with any State agency that may require registration.

By signing below, I further certify that I understand this Contract is subject to the provisions of West Virginia Code W. Va. Code R. §144-3-1 et seq. which automatically voids certain contract clauses that violate State law.

Quinn Evans	Principal, Chief Operating Officer
Company	Title
Thomas C. Jester, FAIA, FAPT, LEED AP	December 4, 2025
Authorized Name	Date
	
Authorized Signature	

SECTION SIX: ATTACHED FORMS AND DOCUMENTS

ADDENDUM ACKNOWLEDGMENT FORM SOLICITATION #AEOI TOR2600000003

Instructions: Please acknowledge receipt of all addenda issued with this solicitation by completing this addendum acknowledgment form. Check the box next to each addendum received and sign below. Failure to acknowledge addenda may result in bid disqualification.

Acknowledgment: I hereby acknowledge receipt of the following addenda and have made the necessary revisions to my proposal, plans and/or specification, etc.

Addendum Numbers Received:

(Check the box next to each addendum received)

- ☒ Addendum No. 1
- ☒ Addendum No. 2
- ☐ Addendum No. 3
- ☐ Addendum No. 4
- ☐ Addendum No. 5

I understand that failure to confirm the receipt of addenda may be cause for rejection of this bid. I further understand that any verbal representation made or assumed to be made during any oral discussion held between Vendor's representatives and any state personnel is not binding. Only the information issued in writing and added to the specifications by an official addendum is binding.

Quinn Evans

Company

Thomas C. Jester, FAIA, FAPT, LEED AP

Authorized Name



Authorized Signature

Principal, Chief Operating Officer

Title

December 4, 2025

Date

NOTE: This addendum acknowledgment should be submitted with the bid to expedite document processing.

Firm Profile & Qualifications



QUINN EVANS



Michigan Central Station

Sustain | Renew | Reimagine

We see **limitless possibilities** in the interplay between quality of place and character of community. It is our promise to empower people and places to thrive and our commitment to deliver solutions with **powerful, resilient, and lasting impact**. Our work is informed and guided by our roots in preservation—with a respect for heritage and history as well as an awareness of context, along with the belief in the power of sustainability in the delivery of high-performance projects. Our award-winning portfolio touches on many aspects of life: **living, learning, culture, and heritage**.

Quinn Evans is proud that our culture of excellence in design on a diverse range of project scales, construction types, and communities, has allowed us to grow from a company of two, to a nationally recognized firm of over 200 professionals in six office locations. In 2022, we became a **majority Women-Owned Business Enterprise**, and our focus on improving design by increasing the diversity of voices contributing to solutions is evident in the minority representation at all levels. Our inspired solutions evolve from diverse expertise in **architecture, preservation planning and design, interior design, and landscape architecture**.

Relevant Experience



MODERN ERA ARCHITECTURE

The preservation of iconic Modern landmarks requires diverse skills and a thoughtful, studied approach. QE's portfolio reflects our commitment to the sensitive renovation, reuse, and transformation of these buildings, including research and documentation, evaluation for nominations to the National Register of Historic Places, renewal master planning, and comprehensive rehabilitation design.

QE's work on diverse Modern structures has given us a deep understanding of both the attributes and limitations of mid-century design and construction. We are aware of the typical problems of modern-era structures that have survived to the present day – life safety deficiencies, lack of accessibility, poor energy and building performance, materials degradation, etc. – and have developed successful integrated design solutions to address and resolve these complex issues in an elegant, efficient, and economical manner.



MUSEUM PLANNING & DESIGN

Through over 30 years of successful cultural project development, we have honed our design process to foster creative, collaborative, and pragmatic designs that reflect the purpose, message, and vision of their institutions while amplifying perceived connections with their unique resources and communities. We have worked with museums of all sizes and specialties, from historic house museums to the iconic Smithsonian Institution museums in our nation's capital.



PERFORMING ARTS

Our portfolio encompasses performance spaces ranging from small community theaters and civic opera houses to the University of Michigan's 3,600-seat Hill Auditorium. With deep experience in the special issues involved in the planning and design of performing arts spaces, our professionals are equipped to address the unique needs of performance facilities.

We have provided solutions to a wide range of design challenges, from feasibility studies for the conversion of historic movie houses to live performance to programming, to designing new performance venues on college campuses. In all cases, our goal is to help communities foster pride and engagement through arts initiatives.



The American Institute of Architects
2024 Architecture Firm Award Recipient



Silling

Local Architect

Silling is a design-oriented architectural, planning, and interiors firm that is intensely committed to passionate service and a comprehensive response to our clients' distinct needs. We are fascinated with the study of place and time, informing a design process that adds relevance and meaning to our clients' stories. We are an award-winning legacy West Virginia architectural firm with beginnings back in 1902, decades of service to generations of West Virginians and showcasing a rich variety of building types where we live, work, and play.

At Silling, we place an extraordinarily high value on client and stakeholder relationships. We pour ourselves into each design effort with expert leadership, servant humility, innovative execution, and a dedication to being a thoughtful partner. We're committed to **Getting It Right** in design, service, and relationships.

Relevant Projects:

West Virginia Culture Center (Firm Legacy Project) State of West Virginia | Charleston, WV

Located just to the west of the State Capitol, this 180,000 square foot campus icon was designed to showcase the Mountain State's artistic, cultural, and historic heritage.

Kanawha County Public Library Kanawha County Public Library | Charleston, WV

An award-winning expansion and renovation of a downtown historic public library. The project included a 20,000 square foot modern addition and 80,000 square feet of renovations, historic preservation and exterior restoration, and new exterior lighting.

Martinsburg City Hall Renovation City of Martinsburg | Martinsburg, WV

Exterior façade re-design and interior renovations to an existing two-story, 22,000 square foot city hall, reimagining it as a relevant civic building appropriately marking its place in time in Martinsburg's historic downtown context.

Cabarrus County Courthouse Cabarrus County Government | Concord, NC

A 240,000 square foot courthouse expansion, as well as 72,000 square feet in renovations to the existing 1975 courthouse, delivering a relevant and contextually sensitive place for justice and civic engagement within Concord's charming downtown district.



Company Information

405 Capitol Street, Upper Atrium
Charleston, West Virginia 25301

304.346.0565

Silling.com

Business Certification

Corporation

Other Information

With design studios located in Charleston, West Virginia and Orlando, Florida, our work has been recognized with 30 design awards since 2004 through various Chapters of the American Institute of Architects.

Leadership Team

Jody Driggs, AIA - Principal, CEO
Chad Wentz, AIA, IIDA - Principal
Michael LeBoeuf, FAIA - Design Director
Brian Estep, AIA - Studio Director
Marie McCauley, AIA - Studio Director
Mike Moore - Director of Bus. Dvpmt.
Rachel Driggs - Director of Admin.

Project Team



Team Organization

DEPARTMENT OF TOURISM



QUINN EVANS | Prime Architect & Historic Preservation
in association with **SILLING | Local Architect**

LEADERSHIP TEAM

Thomas Jester
FAIA, FAPT, LEED AP
Principal in Charge &
Historic Preservation Expert | *Quinn Evans*

Jody Driggs
AIA
Principal | *Silling*

Kathryn Slattery*
AIA, LEED AP
Cultural Project Expert & Sr. Project Manager
**Primary Point of Contact | Quinn Evans*

Brian Estep
AIA
Local Project Management Support | *Silling*



PROJECT TEAM

Sara Langmead
AIA, PE, LEED AP
Project Architect | *Quinn Evans*

Marie McCauley
AIA
Local Project Architect
Support | *Silling*

Susan McLane
ASSOC. AIA
Local Interior
Designer | *Silling*

SPECIALIZED EXPERTISE

Charles Sparkman
AIA, LEED AP BD+C
Technical Lead | *Quinn Evans*

Shannon Wray
CID, LEED AP
Library Expert & Sr. Interior
Designer | *Quinn Evans*

Beth Barrett
AIA, AANB
Cultural Space
Lead Designer | *Quinn Evans*

Fred Pack
Construction Administrator | *Silling*



CONSULTANTS*

WDP & Associates
Forensic Structural and
Building Envelope Engineering

Schuler Shook
Theater Planning

VDA
Vertical Transportation

Mueller Associates
Mechanical, Electrical,
Plumbing, and Fire Protection
Engineering

Threshold
AV / Acoustics Consultant

KDM
Cost Estimating

M2H Protection
IT / Security Consultant

**Additional consultants can be engaged as needed, dependent upon assessment.*

Consultant Team

WDP

Structural Engineering

WDP performs around 100 roof, building envelope, and façade assessments, and structural investigation and repair projects every year. **Most of WDP's repair projects involve facilities that must remain occupied and operating "business as usual" throughout the investigation and repair process.** WDP routinely works in museums and cultural spaces that require a different level of attention to interior climate controls and protection of interior building components. They recognize the importance of preserving artifacts and special collections that have historic significance. WDP has performed building envelope repairs or restoration on a multitude of museums, theaters, libraries, and cultural spaces.

MUELLER ASSOCIATES, INC.

MEP & Fire Protection Engineering

Mueller Associates, Inc. specializes in complex projects in the cultural, education, and government sectors, designing high-performance systems that meet demanding strict functional, environmental, and sustainability standards. Mueller has led MEP studies, system replacements, and phased, occupied renovations for major cultural institutions, including the **Smithsonian Institution's National Air and Space Museum and Administrative Headquarters**, the **Eisenhower and Terrace Theaters at the Kennedy Center for the Performing Arts**, and the **Chesapeake Shakespeare Theater**. Additional work includes historically sensitive renovations at the **National Academy of Sciences**, the **Baltimore Museum of Art**, **National Museum of Women in the Arts**, and **George Washington University's Corcoran School of the Arts and Design**.

SCHULER SHOOK

Theatre Planning

Valued internationally as creative and insightful design partners, Schuler Shook consistently creates exceptional design solutions in theatre planning, audio video design, and architectural lighting design. With over 39 years of experience, they are fully engaged in understanding and elevating the project vision. From initial planning studies to full theatre consulting services, Schuler Shook is known for their inclusive and comprehensive approach to design as well as their success in helping to create facilities that empower and strengthen artists, audiences, and communities.

THRESHOLD ACOUSTICS

AV / Acoustics

Threshold's team of experts in acoustic and audio/video design create places of gathering to learn, share wisdom, and pass along culture. Threshold strives to understand what is unique about and important to the Client, identify the acoustic attributes of each space that derive from those unique aspects, and then pursue and defend those attributes with vigor and good humor through the entire duration of design and construction.

M2H PROTECTION

IT / Security

M2H Protection is a specialized design firm focused in security and telecommunications. The firm consists of seasoned professionals with 25 years' experience practicing security and telecommunications systems design and consulting. M2H brings a wealth of knowledge and specialized services in multicultural environments, libraries and special collections, cultural properties, smart classrooms and collaborations spaces, and educational facilities.

VDA

Vertical Transportation

VDA is the global leader in vertical transportation consulting and inspection services. They provide clients with leading-edge solutions that save them time and, in many cases, money. With offices across North America, decades of industry expertise, and multiple projects in North America and across the globe, VDA leads the way in elevator/escalator consulting and inspection services.

KDM

Cost Estimating

With over 40 years in construction, KDM has estimated numerous commercial, industrial, and institutional projects throughout West Virginia. Their team of construction professionals delivers cutting-edge, comprehensive cost consulting services that meet the industry's highest standards. As a Lifetime Certified Professional Estimator (LCPE), President Dan Moore follows the American Society of Professional Estimators' Standard Estimating Practice Manual guidelines, and he uses the Construction Specifications Institute (CSI) master format for detailed estimates.

Thomas Jester

FAIA, FAPT, LEED AP | Principal in Charge & Historic Preservation Expert

With over 30 years of experience in the field of architecture with a focus on historic preservation, Tom has worked on projects for both public and private clients. His project experience ranges from designing rehabilitation projects and additions, surveying existing conditions, to preparing historic preservation studies and master plans. His wide-spread experience on projects spanning from the 18th, 19th, and 20th centuries has built a strong base to assess both significance and historic integrity. Through this work, coupled with a deep understanding of materials science, he consistently makes sound decisions regarding preservation treatments and goals. He is skilled at managing clients and developing consensus for complex planning and design projects that involve historic buildings and multiple stakeholders.

National Air and Space Museum Washington, DC

Preservation Principal for a multi-year, multi-phased revitalization of one of the most visited museums in the world. In addition to refreshing all exhibition and public spaces throughout the 687,000 sf facility, the comprehensive renovation includes exterior envelope repairs, the renewal of HVAC systems, and the expansion of visitor amenities to create a museum for the 21st century. Tom led the development of a new enclosure design to meet the museum's aesthetic, technical, and security requirements while respecting the original design intent, and worked with multiple historic review agencies to get the design approved.

Daughters of the American Revolution Headquarters Washington, DC

Principal in Charge for multiple interior projects at this National Historic Landmark, including the restoration of public spaces within Constitution Hall. All renovation work was performed while the building remained fully functional and occupied. Tom oversaw the work of preservation architects during the renovation of the Constitution Hall lobbies. He also provided interface to establish overall project goals and translate them to the production team.

IDIQ Contract, Architect of the Capitol Washington, DC

Principal in Charge for the past 8 years on consecutive IDIQs for the Architect of the Capitol. Projects involve master planning, historic preservation and restoration, security upgrades, accessibility improvements and include full architectural and engineering services for implementation through construction.



Registration & Certification

Registered Architect in [WV](#), DC, DE, KS, KY, LA, MD, ME, OK, PA, RI, VA

LEED Accredited Professional

Education

M.Arch, University of Maryland, 1999

MS in Historic Preservation,
University of Pennsylvania, 1991

BA in American Studies,
Colby College, 1988

Professional Affiliations

American Institute of Architects,
College of Fellows

Association for Preservation Technology
International: Board of Directors

DOCOMOMO International

DOCOMOMO US, DC Chapter: Founder,
Treasurer

GSA: National Register of Peer
Professionals

Thomas Jester | FAIA, FAPT, LEED AP

Federal Reserve Board Headquarters

Washington, DC

Principal in Charge for the restoration, renovation, and expansion of two of the Federal Reserve Headquarters' three buildings: the Marriner Eccles Building, the Board's historic home; and 1951 Constitution Avenue, a new acquisition across 20th Street from Eccles. The design for the modernization respects and maintains the buildings' historic character while almost doubling their size (from 390,000 sf to 770,000 sf) via infill additions. Modern building, information technology, and security systems will be seamlessly integrated into the historic fabric. The project is targeting LEED Platinum certification.

Old City Hall

Richmond, Virginia

Principal in Charge for the comprehensive restoration and renovation of Old City Hall, a National Historic Landmark, to serve as offices for Virginia state government staff. The design addresses the deteriorated interior finishes, restores the stone building envelope, and provides interior spaces that allow for flexible use and which can be easily modified for a variety of state government departments.

Facilities Assessment, AIA National Headquarters

Washington, DC

Senior Historical Architect for the development of a renewal study for its headquarters, a 180,000 sf modern-era building built in 1973 and designed by The Architect's Collaborative. The Renewal Master Plan included four main components: greening and sustainability; workplace transformation; space utilization; and existing conditions documentation and stewardship. The document established the framework and guiding principles for planned renewal.

National Academy of Sciences

Washington, DC

Project Manager for the comprehensive rehabilitation and restoration of the headquarters facility for this national organization. The original building was designed by Bertram Goodhue in 1924 with east, west and north wings designed by Wallace Harrison of the modernist firm Harrison & Abramovitz and added in 1962, 1965 and 1970 respectively. Pre-design work incorporated the development of a building preservation study. The multi-function building houses a variety of meeting and conference rooms, a 500 seat auditorium, office space for 140 staff, a cafeteria, and a library.

Jody Driggs

AIA, NCARB | Principal

Jody is a twenty-nine year member of Silling and has served as a Principal since 2001. Under his leadership, the firm has grown in expertise and recognition as a regional thought leader in judicial and governmental planning and design. Jody's work has received dozens of design awards, elevating pragmatic justice planning with a focus on cultural connections to people and place. Through his background in campus planning and urban design, Jody understands his projects' responsibilities in shaping engaging civic spaces, contributing to a public realm that reflects and reinforces our societal values. The variety of architectural language and character in the firm's work is evidence of his approach and commitment to client-centeredness and critical design.

West Virginia Culture Center Curtainwall Replacement WV Department of Tourism | Charleston, West Virginia

Local Principal Architect in collaboration with WDP & Associates for the assessment and design of this window replacement project.

Kanawha County Public Library Kanawha County Public Library | Charleston, West Virginia

Principal in Charge for an award-winning expansion and renovation of a downtown historic public library. The project included a 20,000 square foot modern addition and 80,000 square feet of renovations, historic preservation and exterior restoration, and new exterior lighting.

Cabarrus County Courthouse Cabarrus County Government | Concord, North Carolina

Design Principal for a 240,000 square foot courthouse expansion, as well as 72,000 square feet in renovations to the existing 1975 courthouse, delivering a relevant and contextually sensitive place for justice and civic engagement within Concord's charming downtown district.

D. Stephen & Diane H. Walker Convocation Center West Virginia State University | Institute, West Virginia

Principal in Charge for a new 1,300-seat collegiate arena addition to an existing historic athletic and academic building. The project included 70,000 square feet of additions and renovations to the 1892 Fleming Hall to meet the needs of modern-day teaching, learning, recreation, and varsity competition.



Registration & Certification

Registered Architect: **WV**, FL, MD, PA, VA, KY, OH, NC
NCARB Certified

Education

B.Arch, University of Tennessee, 1996

Professional Affiliations & Credentials

American Institute of Architects

National Council of Architectural
Registration Boards (NCARB)

AIA Academy of Architecture for Justice

AIA West Virginia Scholarship
Committee

Past-President, AIA West Virginia

Past-Chair, WV Foundation for
Architecture

Kathryn Slattery

AIA, LEED AP | Cultural Project Expert & Sr. Project Manager

Kathryn provides innovative design solutions for public facilities. Working to integrate buildings with surrounding site systems and environments, she is skilled at balancing disparate project needs and coordinating complex interdisciplinary systems. She brings an exceptional ability to ensure a project's design intentions are fulfilled through a clear, proactive, and positive management and communication style that is a key contributor to project success.

Production Facility Renewal

Architect of the Capitol Botanic Garden | Washington, DC

Principal in Charge for the modernization of the existing production facility site and buildings including the addition of a community centered Learning Center Complex with Urban Farm. Existing facilities have outdated, inefficient, and high-energy consuming systems and innumerable safety hazards to operate and maintain. This once-in-a-lifetime project is targeted to have a life span of greater than 50 years and will come online after a series of phased construction efforts. The development of this effort is in alignment with Architect of the Capitol (AOC) standards, objectives, and policies and incorporates best practices for horticultural care and sustainability. Following the completion of the master plan, QE completed programming for the site in 2021 and has begun design on the entire facility - greenhouse, outdoor growing and education center, and urban farm. Construction will be phased over five years and operations will be maintained on site throughout. Kathryn was responsible for overseeing all project progress and coordination of the multi-disciplinary team to deliver all project goals.

Multiple Building Assessments

National Zoological Park | Washington, DC

Architectural Staff for the field survey and assessment of more than 90 buildings on the Olmsted-designed National Zoo campus. Following the survey phase of the project, a report was prepared to summarize the results and set the foundation for over a dozen discrete projects to be executed over the following ten years.

Smithsonian Institution IDIQ Contract

Washington, DC

Project Manager for a multi-disciplined team providing services under an indefinite delivery contract to the Smithsonian Institution since 1999. Work has encompassed projects located at the National Museum of Natural History, Hirshhorn Museum & Sculpture Garden, National Museum of American History and the 163 acre National Zoological Park as well as other Institution assets such as the Museum Support Center. The contract value is \$2 million per year with projects ranging from \$100,000 to \$32 million.



Registration & Certification

Registered Architect: MI, DC, AL, NC, NH
NCARB Certified
LEED Accredited Professional

Education

M.Arch, University of Michigan, 2003
B.Arch, Catholic University of America, 2001

Professional Affiliations

American Institute of Architects
Association of Zoos and Aquariums

Brian Estep

AIA, NCARB | Local Project Management Support

Brian is a Studio Director in the Charleston office. In his 33 years of experience, Brian has cultivated a career delivering impactful design solutions across justice, law enforcement, public safety, civic and educational building types – each crafted with a deep understanding of function, security and community engagement. Throughout his career Brian has collaborated with multidisciplinary teams and stakeholders to ensure every project resonates with its users while standing the test of time. He is driven by a passion for clean, purposeful design – spaces where form meets function and clarity encourages confidence. He approaches every project with an emphasis on thoughtful planning, quiet precision and a belief that thoughtful, well-executed design can elevate how people live, work and connect.

West Virginia Culture Center Curtainwall Replacement WV Department of Tourism | Charleston, West Virginia

Local Project Manager and Architect in collaboration with WDP & Associates for the assessment and design of this window replacement project.

Kanawha County Public Library

Kanawha County Public Library | Charleston, West Virginia

Project Manager for an award-winning expansion and renovation of a downtown historic public library. The project included a 20,000 square foot modern addition and 80,000 square feet of renovations, historic preservation and exterior restoration, and new exterior lighting.

Martinsburg City Hall Renovation

City of Martinsburg | Martinsburg, West Virginia

Senior Project Architect for an exterior façade re-design and interior renovations to an existing two-story, 22,000 square foot city hall, reimagining it as a relevant civic building appropriately marking its place in time in Martinsburg's historic downtown context.

D. Stephen & Diane H. Walker Convocation Center

West Virginia State University | Institute, West Virginia

Project Manager for a new 1,300-seat collegiate arena addition to an existing historic athletic and academic building. The project included 70,000 square feet of additions and renovations to the 1892 Fleming Hall to meet the needs of modern-day teaching, learning, recreation, and varsity competition.



Registration & Certification

Registered Architect: [WV](#)

NCARB Certified

Education

B.Arch, University of Tennessee, 1992

Professional Affiliations & Credentials

American Institute of Architects

National Council of Architectural
Registration Boards (NCARB)

AIA Academy of Architecture for Justice

Sara Langmead

AIA, PE, LEED AP | Project Architect

Sara focuses on the restoration and reuse of existing buildings, practicing both as an architect and as an engineer. Her approach to design integrates preservation with sustainability and modern user requirements. Her passion lies in reinventing places from the past to enrich and better serve the needs of the future. Her expertise encompasses architectural design, preservation technology, condition analysis, building envelope design, and the management of large and small-scale projects. Sara is experienced in the investigation and remediation of water infiltration and masonry deterioration.

IDIQ Contract, Architect of the Capitol Washington, DC

Project Architect for the past 8 years on consecutive IDIQs for the Architect of the Capitol. Projects involve master planning, historic preservation and restoration, security upgrades, accessibility improvements and include full architectural and engineering services for implementation through construction.

Federal Reserve Board Headquarters Washington, DC

Project Architect for the restoration, renovation, and expansion of two of the Federal Reserve Headquarters' three buildings: the Marriner Eccles Building, the Board's historic home; and 1951 Constitution Avenue, a new acquisition across 20th Street from Eccles. The design for the modernization respects and maintains the buildings' historic character while almost doubling their size (from 390,000 sf to 770,000 sf) via infill additions. Modern building, information technology, and security systems will be seamlessly integrated into the historic fabric. The project is targeting LEED Platinum certification.

Old US Naval Observatory Washington, DC

Architect for the development of a Master Plan for this historic government building originally built in 1843. The plan addressed issues relating to the building's mechanical, electrical, and plumbing systems, as well as compliance with current building safety codes and ADA accessibility. Subsequent implementation projects have focused on repairs to the exterior envelope.

Boucke Building Pennsylvania State University | University Park, Pennsylvania

Project Architect for an exterior envelope rehabilitation of this 1957 academic building. Our design creates synergies between masonry repairs and window replacement to improve both the building's appearance and energy performance.



Registration & Certification

Registered Architect
Professional Engineer
LEED Accredited Professional

Education

MA in Historic Preservation, University of Maryland, 2010
M.Arch, University of Maryland, 2009
BS in Civil Engineering, Columbia University, 2002

Professional Affiliations

American Institute of Architects
Association of Preservation Technology
Baltimore Heritage
Baltimore City Commission for Historical and Architectural Preservation (CHAP), Commissioner
National Trust for Historic Preservation
Preservation Maryland

Marie McCauley

AIA | Local Project Architect Support

As a firm Director of Silling's Charleston design studio, Marie leads the team with a focus on thoughtful design, strong collaboration, and exceptional client service. With more than 18 years of experience across justice, civic, health + wellness, and educational projects, she brings a well-rounded and informed perspective to every engagement. Marie oversees studio resourcing and remains hands-on as a project architect, guiding project teams through the design process, and ensuring our work consistently meets the firm's standards for quality and client satisfaction. Clients and colleagues appreciate Marie's aptitude for organization, clear communication, and cultivating a studio culture where great ideas and strong teamwork thrive.

Davis Fine Arts Center Renovation

West Virginia State University | Institute, West Virginia

Greenbrier County Courthouse Expansion & Renovation

Greenbrier County Commission | Lewisburg, West Virginia

Marshall County Courthouse Expansion & Renovation

Marshall County Commission | Moundsville, West Virginia

Harrison County General Administrative Services Annex

Harrison County Commission | Clarksburg, West Virginia



Registration & Certification

Registered Architect

Education

B.Arch, University of Tennessee, 2007

Professional Affiliations & Credentials

American Institute of Architects

AIA Academy of Architecture for Justice

AIA WV President, 2022-2023

AIA West Virginia Director, 2020-2021

AIA Young Architect Regional Director,
Virginias Region, 2018-2019

Susan McLane

Associate AIA | Local Interior Designer

As Silling's principal Interior Designer, Susan utilizes her 30 years of commercial design knowledge, project experience and creative passion to develop physically and emotionally pleasing environments. She also partners closely with our architectural staff – from the conceptual design, selecting appropriate building materials and colors – all the way through to the final stages of selecting and specifying furniture and fixtures that ultimately bring about a complete and cohesive building design.

Martinsburg City Hall Renovation

City of Martinsburg | Martinsburg, West Virginia

Young Life Wild Ridge Camp - Gauley Lodge

Young Life | Mt. Nebo, West Virginia

Southampton County Courthouse Expansion & Renovation

Southampton County Government | Courtland, Virginia

Cabarrus County Courthouse

Cabarrus County Government | Concord, North Carolina



Education

Graduate of The Art Institute of
Pittsburgh, 1996

Professional Affiliations

American Institute of Architects

Charles Sparkman

AIA, LEED AP BD+C | Technical Lead

Charles Sparkman's integrated design approach synthesizes art, building science, and research into architecture that is rich in meaning and beautiful in craft. He combines analytical, data-driven methodology with sophisticated design strategies to create timeless, performance-based design. Charles' diverse portfolio includes many distinctive cultural, civic, and educational projects. He is adept in the design of complex historic preservation projects as well as new construction that helps define and elevate campuses and communities. Charles advocates for rigor and clarity in the architectural role, valuing a collaborative approach with clients and team members to achieve design excellence.

Federal Reserve Board Headquarters

Washington, DC

Longworth House Office Building Façade Restoration

Washington, DC

National Air and Space Museum

Washington, DC

Production Facility Renewal

Architect of the Capitol Botanic Garden | Washington, DC



Registration & Certification

Registered Architect

LEED Accredited Professional, Building Design + Construction

National Council of Architectural Registration Board Certified

Education

M.Arch, University of Virginia, 2012

BA in Art History and Visual Culture Studies, Minor in Visual Arts, Duke University, 2009

Professional Affiliations

American Institute of Architects

US Green Building Council

Construction Specifications Institute

Beth Barrett

AIA, AANB | Cultural Space Lead Designer

Beth provides deep experience in the transformation of performing arts centers, visitor centers, and museums. A hallmark of her work is the use of design thinking to guide change for patrons, visitors, and staff. She specializes in community engagement and developing architectural programming that provides integrated visitor experiences for cultural institutions and meets stringent technical requirements.

Constitution Hall

Daughters of the American Revolution Headquarters | Washington, DC

Terrace Theater, Eisenhower Theater, and Concert Hall

John F. Kennedy Center for the Performing Arts | Washington, DC

Production Facility Renewal

Architect of the Capitol Botanic Garden | Washington, DC

Michigan State Capitol Heritage Hall

Lansing, Michigan



Registration & Certification

Registered Architect

NCARB Certified

Education

M.Arch, Virginia Polytechnic Institute & State University, 2009

B.EnvD, Texas A&M University, 2002

Professional Affiliations

American Institute of Architects

Architect's Association of New Brunswick

Shannon Wray

CID, LEED AP | Library Expert & Sr. Interior Designer

A Principal at QE, Shannon is a Senior Interior Designer and provides design leadership for programming, space planning, lighting, acoustics, finish materials, color selections, and furniture / furnishings. Building on her knowledge gained through experience and research she will have a design leadership role in the programming, planning and concept phases of the library design working closely with other team members. She will remain continuously involved during the subsequent phases of the work through construction and occupancy.

Southeast Neighborhood Library
Washington, DC

Suffolk Downtown Library
Suffolk, Virginia

Woodlawn Branch Library
Baltimore County, Maryland

Henrico Libraries
Henrico County, Virginia



Registration & Certification

Certified Interior Designer
LEED Accredited Professional

Education

BFA in Interior Design, Virginia
Commonwealth University, 1999

Professional Affiliations

American Library Association

Fred Pack

Construction Administrator

Fred's strength comes from his diverse background in multiple roles over the last 30 years as a construction administrator in the architectural field, as well as a superintendent/project manager in the construction industry, giving him a unique perspective and an appreciation of how buildings are constructed. His responsibilities include a full range of construction supervision duties including coordination and scheduling of trade contractors, material suppliers and construction team employees, liaison for project owners and architects/engineers, and quality assurance.

West Virginia Lottery Headquarters
West Virginia Lottery | Charleston, West Virginia

Afton Ridge Library & Active Living Center
Cabarrus County Government | Kannapolis, North Carolina

Lewis County Judicial Annex
Lewis County Commission | Weston, West Virginia

Monongalia County Justice Center
Monongalia County Commission |
Morgantown, West Virginia



Previous Experience

Paramount Builders, Field
Superintendent, 2011-2012

BBL Construction, Project
Superintendent, 2000-2010

United Brotherhood of Carpenters and
Joiners of America Locals #302 and 283,
1984-1994

United States Air Force, Honorably
Discharged, 1981-1984

Professional Affiliations

American Institute of Architects

Rex Cyphers

PE | Principal Structural Engineer

Rex is WDP's Vice President and Chief Operating Officer with 23 years of experience. He specializes in the design and repair of masonry structures, historic preservation, and nondestructive testing. He performs forensic field, façade, roofing, waterproofing, and building envelope investigations; structural inspection / analysis and design; architectural retrofit and repair; and develops design documents and repair recommendations.

Diamond Building Roof / Parapet Repairs
West Virginia General Services Division |
Charleston, West Virginia

Building 37 Window, HVAC, Roof, and Envelope Investigation & Upgrades
West Virginia General Services Division |
Charleston, West Virginia

New Roc City Water Leakage Investigation and Repair
Acumen Development | New Rochelle, New York



Registration & Certification

Professional Engineer: WV, CT, IL, LA, PA, TN, VA

Education

MS, Civil Engineering, West Virginia University, 2003

BS, Civil Engineering, West Virginia University, 2002

Graduate Certificate, Cultural Resource Management, West Virginia University, 2003

Professional Affiliations

ASTM Subcommittee E06.24 Preservation and Rehabilitation Technology



Byoung-Jun (BJ) Lee

PHD, PE, SE | Lead Structural Engineer

BJ joined WDP in 2006 and has 22 years of professional experience. He specializes in architectural engineering and structural engineering services including failure investigations, analysis, and repair design. BJ has expertise in structural analysis and repair, evaluation of existing structures, and nondestructive testing of concrete structures. He has also written more than 15 technical papers in technical journals and proceedings.

Health Sciences Building, Building Envelope Replacement Study and Design
West Virginia University | Charleston, West Virginia

One-Tribe Place Post-tensioned Concrete Evaluation and Repair Design
College of William & Mary | Williamsburg, Virginia

US Capitol Power Plant, Ash Silo
Architect of the Capitol | Washington, DC



Registration & Certification

Professional Engineer: WV, VA, DC, MD
Structural Engineer: HI

Education

PhD, Civil and Environmental Engineering, Lehigh University, 2003

MS, Architectural Engineering, Kangwon National University, 1996

BS, Architectural Engineering, Kangwon National University, 1994

Professional Affiliations

American Concrete Institute
American Institute of Steel Construction
Post Tensioning Institute



Adam D'Alessandro

PE | Lead Envelope Engineer

Adam has 17 years of industry experience working on a wide variety of building envelope and structural engineering projects. Over 13 years at WDP, he performed condition assessments, failure investigations, rehabilitation of existing structures, development of repair designs and specifications, field testing, and construction administration services.

Albert V. Bryan Sr. US Courthouse

General Services Administration | Baltimore, Maryland

Water Leakage Investigation

Roanoke Higher Education Center | Roanoke, Virginia

State Capitol Repair Replacement Project

Virginia Department of General Services |
Richmond, Virginia



Registration & Certification

Professional Engineer: VA

Education

MS, Civil Engineering, Clemson
University, 2007

BS, Civil Engineering, Clemson
University, 2005



Thomas Syvertsen

PE, LEED AP | Mechanical Engineer

Thomas has extensive experience leading mechanical engineering upgrades for historic, cultural, and multi-use institutional facilities. He has directed assessments and renovations for museums, theaters, and archival spaces, modernizing aging infrastructure while preserving each facility's character. Tom specializes in HVAC evaluations, system upgrades, and integrating new solutions into architecturally significant environments, like those for the West Virginia Culture Center.

National Air and Space Museum Revitalization

Smithsonian Institution | Washington, DC

Administrative Headquarters

Smithsonian Institution | Washington, DC

Eisenhower Theater

Kennedy Center for the Performing Arts | Washington, DC

Chesapeake Shakespeare Theater Renovation

Chesapeake Shakespeare Company | Baltimore, Maryland

National Academy of Sciences Renovation

Washington, DC



Registration & Certification

Registered Professional Engineer (PE):
MD, DC, GA, NC, VA, WV

LEED Accredited Professional

Education

BS in Mechanical Engineering, Messiah
College, 2002

Professional Affiliations

American Society of Heating,
Refrigerating, and Air-Conditioning
Engineers (ASHRAE)



Adam Fry

PE | Electrical Engineer

Adam has extensive experience managing electrical engineering services for renovation of historic, cultural, and public facilities. He has led electrical assessments and renovations for museums, visitor centers, and multi-use institutional buildings, with a focus on modernizing critical infrastructure while respecting the historic character. Adam specializes in power distribution, lighting, life-safety systems, and integrating new electrical solutions, positioning him to support the electrical engineering assessment of the West Virginia Culture Center.

National Air and Space Museum Revitalization
Smithsonian Institution | Washington, DC

Terrace Theater
Kennedy Center for the Performing Arts | Washington, DC

Baltimore Museum of Art Renovation and Expansion
Baltimore, Maryland

National Academy of Sciences Renovation
Washington, DC



Registration & Certification

Registered Professional Engineer (PE):
MD, DE, DC, GA, MI, NJ, NC, VA, [WV](#)

Education

B.Arch Engineering with Lighting/
Electrical Emphasis, Pennsylvania State
University, 2001



Karen Schulte

PE, CPD, LEED AP BD+C | Plumbing &
Fire Protection Engineer

Karen brings extensive expertise in evaluating and upgrading plumbing and fire protection systems for complex, historically significant facilities. Her experience includes museums, visitor centers, and public institutions where infrastructure reliability and preservation must be carefully balanced. Karen is known for her thoughtful approach to modernizing piping, water distribution, and life-safety systems in occupied, culturally sensitive environments. Her background will be essential to guiding the plumbing and fire protection assessments for the West Virginia Culture Center.

National Air and Space Museum Revitalization
Smithsonian Institution | Washington, DC

National Museum of Women in the Arts
Washington, DC

Corcoran School of the Arts and Design
George Washington University | Washington, DC

National Academy of Sciences Renovation
Washington, DC



Registration & Certification

Registered Professional Engineer (PE):
MD, DC, VA

LEED Accredited Professional, Building
Design and Construction

Certified Plumbing Designer

Education

B.Arch Engineering with Mechanical
Emphasis, Pennsylvania State University, 2006

Professional Affiliations

American Society of Plumbing Engineers
(ASPE), Women of ASPE Liaison

American Society of Heating, Refrigerating,
and Air-Conditioning Engineers (ASHRAE)



Joshua Grossman

ASTC | Theatre Planner

Joshua blends creativity with technical theatre experience in his approach to each theatre client and project. He joined Schuler Shook in 2000 after ten years spent as a stagehand, scenic designer, technical director and production manager. Passionate about graceful, sustainable and efficient design, Joshua brings to every project the ability to think laterally to find solutions, drawing on his considerable working knowledge of the multitude of systems designed for today's contemporary performance facilities.

Terrace Theater, John F. Kennedy Center for the Performing Arts
Washington, DC

The Momentary
Crystal Bridges Museum | Bentonville, Arkansas

Constitution Hall
Daughters of the American Revolution | Washington, DC

Center of Creative Arts (COCA),
St. Louis, Missouri

Wallis Annenberg Center for the Performing Arts
Beverly Hills, California



Education

BFA in Scenic Design and Technical Production, Emerson College, 1995

Professional Affiliations

American Society of Theatre Consultants

United States Institute for Theatre Technology

ETCP Certified Rigger - Theatre



Jackson Lasseter

Theatre Specialist

Jackson finds inspiration in performance spaces because they are where he and the people around him - from audience members to the artisans - connect, create, and share experiences together. As a Theatre Specialist, he collaborates with team members to solve problems and design performance venues that serve to support everyone's creativity and ingenuity.

The Salt Shed
16" on Center Chicago | Chicago, Illinois

National Air and Space Museum
Smithsonian Institution | Washington, DC.

Amazon PenPlace
Amazon | Arlington, Virginia

Kimball Recital Hall
University of Nebraska | Lincoln, Nebraska

Dance Building
University of Michigan | Ann Arbor, Michigan



Education

BA in Theatre Design/Technology, Emerson College, 2019

Professional Affiliations

United States Institute for Theatre Technology



Scott D. Pfeiffer

FASA | Acoustics Consultant

For decades, Scott has participated in virtually every aspect of the acoustical consulting profession, from modeling and measurements to leading the design of complex rooms, audio and video installations, and electronic enhancement systems. Scott has been honored as a Fellow in the Acoustical Society of America for his accomplishments in the design of worship and performing arts spaces.

Shenandoah Conservatory
Winchester, Virginia

Rothko Chapel
Houston, Texas

Illinois Holocaust Museum and Education Center
Skokie, Illinois

Cleveland Public Library, MLK Jr. Branch
Cleveland, Ohio

Shure, Inc. Headquarters, S.N. Shure Theatre
Niles, Illinois



Education

Denmark's Technical University (DTU),
Graduate Study, 1993

BS with Honors in Music, Moravian
College, 1992

Professional Affiliations

National Council of Acoustical
Consultants President- Elect 2020,
President 2022 - 2024

Architectural Engineering Industry
Advisory Committee



Tim Perez

CTS-D | AV Consultant

Tim is a Partner at Threshold Acoustics with 15 years experience. He has a dual background in acoustics and engineering. His development of AutoCAD resources and tools has him as the point-person for numerous in-house questions and software needs. In addition to his incredible intelligence in Audio Video systems design, his even-keeled demeanor and dry wit is a valuable asset to the design team.

Arts and Ideals Exhibit
Kennedy Center for the Performing Arts | Washington, DC

Smithsonian Institution Assistive Listening System
Washington DC & New York, New York

Jesse Jones Hall
Friends of Jones Hall | Houston, Texas

Poetry Foundation
Chicago, Illinois

The Guild Lounge
Northwestern University | Evanston, Illinois



Registration & Certification

AVIXA CTS-D

Education

BS in Electrical Engineering with a
concentration in Audio, University of
Miami, 2009

MS in Architectural Acoustics,
Rensselaer Polytechnic Institute, 2011



Mark Hankewycz

CPP, PSP, RCDD | Security & Telecom

Mark has over 30 years of professional expertise in evaluation, planning, design and implementation of physical, electronic, and cyber security systems and information transport systems. He has expertise in applying specialized skill sets in complicated projects often requiring continuity of service often found in federal, military public safety, judicial and other elevated risk sites, and facilities. He brings a broad and in-depth level of expertise in the security of high-risk and sensitive facilities.

Southeast Quad, National Museum of Natural History
Smithsonian Institution | Washington, DC

Special Collections Library & Intercultural Center
Georgetown University | Washington, DC

Baird Auditorium, National Museum of Natural History
Smithsonian Institution | Washington, DC

Facility Wide Electronic Security System Upgrades
John F. Kennedy Center for the Performing Arts |
Washington, DC

National Archives Building
National Archives and Records Administration |
Washington, DC



Registration & Certification

Certified Protection Professional,
ASIS, 2027

Physical Security Professional,
ASIS, 2027

Registered Communications
Distribution Designer, BICSI, 2027

Education

BS in Architecture, Eastern Michigan
University, 1980

Professional Affiliations

Multi-Hazard Mitigation Council,
National Institute of Building Sciences

Premis Security Council, NFPA 730

Security Architectural & Engineering
Council, ASIS International



Robb Parks

Lead Elevator Consultant

Robb joined VDA in 2024 as an Associate in the DC/NOVA & Baltimore, MD areas. His responsibilities include consultation on major repairs, modernizations and upgrades, equipment evaluations, maintenance management and inspection services for vertical transportation systems.

Potter Stewart Courthouse
Cincinnati, Ohio

Johns Hopkins Bayview Medical Center
Johns Hopkins Medicine | Baltimore, Maryland

Greystar Property Management
Arlington, Virginia

Hilton McLean
Tysons Corner, Virginia

Target
Washington, DC



Education

NEIEP Apprenticeship Training
Graduate

Professional Affiliations

IUEC Local #10



Dan Moore

CPE | Cost Estimator

A former long-time cost estimator for one of the region's largest general contractors, Clarksburg-based Dan Moore provides over 36 years' experience in the WV construction marketplace with a primary focus on construction cost estimating. Silling's collaboration with KDM has resulted in an impeccable track record of delivering projects at or under budget for many years.

Kanawha County Public Library Expansion & Renovation

Kanawha County Public Library | Charleston, West Virginia

West Virginia Lottery Headquarters

West Virginia Lottery | Charleston, West Virginia

Monongalia County Justice Center

Monongalia County Commission | Morgantown, West Virginia

D. Stephen & Diane H. Walker Convocation Center

West Virginia State University | Institute, West Virginia

Cabarrus County Courthouse

Cabarrus County Government | Concord, North Carolina



Registration & Certification

Lifetime Certified Professional Estimator (LCPE)

Professional Affiliations

Construction Specifications Institute (CSI)



Project Approach & Objectives



Project Approach

The Needs Assessment for the Culture Center is precisely the type of project at which Quinn Evans excels. The project requires a studied yet practical approach to the existing building, coupled with in-depth knowledge of modern materials and assemblies, and expertise working with both civic and cultural institutions. We will bring the unique capabilities noted below to this project.

Experts in Transforming Existing Buildings

Quinn Evans believes that every existing building and site offer stories to tell, secrets to share, and a bright promise for the future. As specialists in adaptive reuse design, documentation, and research, QE approaches each project as a journey – a process that explores the past, returns to the present, and plans for a robust future. We bring expertise and state-of-the-art tools to transform under-performing buildings into high-performance, technologically rich, adaptive and active based learning environments. Our team is set apart by our knowledge of how to authentically restore and creatively preserve the Culture Center architectural character.



Hirshhorn Sculpture Garden

Modern Era Renovation Expertise

In preserving the most important aspects of architecturally significant post-war buildings, it is also essential to plan to adapt elements strategically and integrate sustainable systems and technology so that the essential values that make a place or building significant are maintained. **Interventions can add new layers of meaning to Modern buildings and heighten awareness of original works of architecture.**

We understand that the Goals and Objectives for this project include:

1. Performing an assessment of the building, preparing comprehensive reports making recommendations for repair, and providing budgetary estimates for multiple, tiered cost-effective solutions.
2. Understanding complex building repairs and renovations, assembling a team with experience and expertise in the associated renovation scope, and skillfully managing that team as well as the project schedule, quality, and costs throughout the duration of the project.
3. Producing designs for and overseeing multiple bid packages in order to phase construction.
4. Implementing construction in occupied spaces.
5. Producing construction documents and administering construction in compliance with the State purchasing regulations.

The Quinn Evans + Silling team's approach to achieving these goals follows our long-standing methodology of Inquiry, Insight & Interpretation to set the path to success for this planning project.

Objectives & Goals

Goal/Objective 1: Building Assessment

Goal 1, which involves completing an assessment of existing conditions, making recommendations for repair and providing tiered cost estimates is the type of project that forms the basis of a vast majority of Qourprojects. Working on existing buildings often begins with assessing and understanding their attributes and deficiencies, so that deficiencies can be addressed, attributes can be maintained and preserved, and new interventions can be planned to transform underperforming buildings into high-performance, technologically rich, innovative, and community-oriented spaces for people. We will bring our in-depth knowledge of modern building materials paired with our expertise working with cultural and civic institutions to provide you with a

thorough, practical and implementable Assessment and Recommendations Report that will serve as the basis/foundation for implementing subsequent projects for Building 9.

We identify three key elements that support a strong assessment planning process: **Inquiry**, **Insight**, and **Interpretation**. In this step-by-step approach, we collect and analyze information to make informed recommendations that focus the next phase of work. At each stage, multi-disciplinary efforts will inform staff and stakeholders to assess how different ideas and alternatives meet project goals and objectives. Throughout the process, stakeholders will be a critical part of the team, bringing their understanding of the Culture Center, its goals, audience, and current operations, as well as their future aspirations, to assist in the decision-making process.



INQUIRY

Our work will start with a review of existing documents, followed by on-site survey by all disciplines of the building spaces, materials, systems and equipment. In consultation with our structural and envelope consultant, WDP, areas that exhibit damage, water intrusion or other deficiencies will be explored further by means of limited selective demolition, air and water leakage testing, etc. WDP has developed extensive expertise in nondestructive testing, especially relating to concrete and masonry, in order to gain an understanding of the existing conditions of structures. We will also use a variety of our standard tools to measure air and/or water leakage in the building to take the guesswork out of proposed repairs.

The culmination of this stage is the project Visioning Workshop. Beginning with the facility's Mission, we will collaboratively establish the project goals and objectives from the perspectives of site, building, education, and interpretation. This includes audience, experience, character, performance, value, operational sustainability, and other key considerations. Interactive workshop sessions and a group site walk will highlight conditions today and imagine their future.

We will establish a firm foundation for success by identifying project goals and objectives, understanding the facility's current uses, and establishing open and reliable project communication and management routines. Understanding context, building history, and the site from the beginning of the process are critical to developing a clear vision that satisfies the wide-ranging requirements essential to project success.



During the existing conditions analysis, we will collect and facilitate a team synthesis of building conditions. We will focus our efforts during this phase on Inquiry – being curious, asking questions, visiting the site, researching data and documents to develop a deep understanding of the building and its programs and operations. Our strength comes from bringing a fresh set of eyes and ears to not only see the site but also hear the stories of what is and is not working within the building.

Together, the team will synthesize many layers of project information into a concise format that serves as a practical and accessible tool for both the client and the design team going forward.

The existing conditions assessment will be provided both as a report and presented in a meeting for discussion.

INSIGHT

Next, the design team will lead the stakeholder group through varied approaches, our assessment of the systems and building functions, and consider future goals and how they align with end users' goals. Together, we will envision a typical visit to each of the main program spaces, and consider typical or public events, touching on issues of arrival, orientation and wayfinding, transitions, and departure, as well as discuss building operation deficiencies. A discussion of defining building character elements will touch on ideas of outside and inside, informal and formal, separation and connections, and other considerations. We will envision how these essential aspects may combine to create a sense of welcome, curiosity, surprise, community, pride, and inspiration. This workshop will also include discussions of opportunities and constraints, and a prioritization exercise guided by the project goals and identified deficiencies.

We will work to identify and prioritize stakeholder participation around an initial list of key issues to be studied. It is critical for the team to understand stakeholder groups and participants who have interest and influence on the project development. Engagements will be formalized in a Stakeholder Engagement Process Document that will be used as a guide throughout the project.

Using the findings from the Inquiry phase as a guide, the team will lead a series of workshops to discuss opportunities for the building renewal, balancing impact and cost. Together, the team will develop the vision and goals into a concise statement that resonates with the client and stakeholders and is high-level and adaptable to serve the life of the project. The results of the Inquiry efforts will also begin to inform the development of functional needs and program areas to address project goals and objectives, along with code and other requirements. The team will provide initial observations on the conditions of existing facilities and systems and their future potential.



INTERPRETATION

Through all three phases, the QE + Silling team will return to the project goals to guide the review and analysis of the diverse project requirements. This approach, along with a clear methodology, is key to creating a plan that responds to the importance of the place, the institution, and its vision in the immediate and long-term.

During Interpretation, concepts will come together to provide a clearly articulated vision for resolving the operational and cultural deficiencies identified in the findings of the first two phases. This will include initial conceptual diagrams, floor plans, elevations, and exteriors, along with the experiential and operational narrative descriptions and conceptual value analysis of the respective concepts.

The benefits and trade-offs of the alternatives, in terms of project goals and objectives, value, and priorities, will also be collaboratively assessed, along with phasing and other program execution options.

Our diverse work in this arena has given us a keen understanding of both the attributes and limitations of post World War II era design and construction. We are aware of the typical problems (experimental materials, life safety deficiencies, lack of accessibility, poor energy and building performance, materials degradation, impacts of hazardous materials, obsolescence of function, and failure of construction methodologies and techniques) and have developed successful integrated design solutions to address and resolve these complex issues in an elegant, efficient, and economical manner.

QE's portfolio includes repair and revitalization of many iconic modern-era buildings including: John F. Kennedy Center for the Performing Arts (Edward Durrell Stone, 1971), American Institute of Architects Headquarters (The Architects Collaborative, 1973), The Rouse Building (Frank Gehry, 1973), National Academy of Sciences (Harrison and Abromovitz, 1962, 1968, and 1973), US Tax Court (Victor Lundy, 1974), US Department of Housing and Urban Development (Marcel Breuer, 1968), National Air & Space Museum (Hellmuth Obata and Kassabaum, 1976), Lafayette Park (Mies van der Rohe, 1956-67), J. Edgar Hoover Building / FBI Headquarters (C.F. Murphy Associates, 1965-75), National Gallery of Art – East Wing (I.M. Pei, 1978), and Arvonne Fraser Library (Ralph Rapson, 1962).

Arvonne Fraser Library





Goal/Objective 2: Experience with complex building repairs and renovations

Meeting Goal 2 requires an intimate understanding of complex building repairs and renovations, assembling a team with experience and expertise in the associated renovation scope, and skillfully managing that team as well as the project schedule, quality and costs throughout the duration of the project.

COMPLEX RENOVATIONS AND BUILDING SYSTEMS IMPROVEMENTS

Building on the findings, assessments and recommendations from the Inquiry, Insights, and Interpretation Phase the Quinn Evans + Silling team will begin an in-depth look at design proposals that marry spatial programming modifications with necessary improvements to all major components of the project. These can be categorized as follows:

- Spatial Improvements, including Great Hall modernization, museum maintenance and upgrades, theater maintenance and upgrades, library modernization, storage upgrades for more efficient use of space, and any other improvements discovered during the assessment.
- Code and life safety improvements, including fire-life safety codes, energy codes and codes related to building systems

- Accessibility improvements, including accessibility improvements at all public spaces, event spaces, and restroom upgrades
- Building Envelope upgrades, including patio deck and well. This work will not include design proposals for roof and windows but will incorporate those planned improvements that may impact other portions of the building
- Materials and finishes upgrades, including marble repair, carpet upgrades, new painting
- MEP system repairs and upgrades, including HVAC equipment and distribution, electrical equipment and distribution, lighting fixtures and controls, plumbing systems
- Fire alarm and sprinkler system upgrades
- Low voltage system improvements including security, telecom and AV systems
- Vertical transportation system and equipment improvements, including elevators, escalators and lifts

Creative problem-solving plays a pivotal role in the renovation design process to optimize the available square footage. To revitalize a building's purpose, we seek innovative solutions to enhance spatial functionality, improve efficiency and flexibility, and integrate technological advancements. This involves a balance between respecting the original design and purposefully introducing novel elements that align with our client's mission, goals and budget.

Meeting current building codes and accessibility requirements can be complex in older structures. Installing features to ensure equity and ADA compliance often requires creative solutions to adapt the building without compromising its character.

Mechanical, life safety and energy codes have all become more stringent since the building's original construction. QE meets with code officials and other project reviewers having jurisdiction early in the design process to highlight these issues and gain consensus so there are no surprises or cost impacts during the permitting process.

Quinn Evans' integrated design approach becomes crucial in ensuring that the architectural vision aligns with structural integrity, building codes, and the comfort of those who will inhabit the space. This design philosophy for complex projects prioritizes adaptability, ensuring that the renovated building remains versatile, resilient, and timeless in the face of future changes. The goal is to create a harmonious and holistic environment that navigates challenges and celebrates the opportunities to transform the existing structure into vibrant, functional spaces for generations to come.

TEAM SELECTION AND EXPERTISE

To address the various project components, we have assembled a highly qualified team to provide comprehensive design services, from assessment to recommendations to full design explorations to documentation, bidding and administering construction phase services. Please refer to the previous sections for general firm qualifications and team member resumes.

TEAM MANAGEMENT

During the design phases, Quinn Evans as prime architect will be responsible for managing the design team. This includes holding and managing the consultant contracts, setting and managing the project schedule, controlling the documentation and deliverables as well as the project budget. Our local partner, Silling, will be involved in all design phases and in all key decision points. Design and assessment activities requiring local presence will be heavily supported by Silling. As the project shifts to Bidding and Construction phases, Silling will take the lead in on-site presence, responsible for ensuring that design intent as shown in project documents is accurately conveyed during Construction Administration services.



PROJECT MANAGEMENT AND COMMUNICATION

Proactive and rigorous communication, collaboration, and team management is the key to success. In general, all communication with the Client shall be from a single point of contact, and for this project that contact will be **Kathryn Slattery**. At the outset of the project, a project directory shall designate the key individuals that will function as the point of contact for any/all consultants firms. The project directory will also identify teammates who are responsible for quality review as well as each consultant firm's BIM manager.

Communication methods will be established at the project outset and will involve a variety of tools and platforms (email, Bluebeam Sessions for posting and real-time editing of PDFs by all team members, MS Teams for real-time editing of Word, Excel and Powerpoint files, MS Teams for hosting virtual meetings and sharing screens and presentations, Miro or MS Teams Whiteboards used during progress meetings to encourage workshop-type participation, sketching and writing on a virtual "whiteboard" to solicit input from everyone on the call, Newforma for project tracking and record-keeping, etc) tailored to the needs and requirements of the West Virginia Department of Tourism.



COST CONTROL

QE is proud of a record of highly successful cost control. By working and communicating with West Virginia Department of Tourism representatives at all phases of the project, we will make sure that everyone is aware of the potential cost implications of the choices available. We view cost control as an active and essential aspect of the design process.

At the outset of a project, we will work together closely to confirm that the budget fits the scope envisioned. With a clearly defined project scope, the client can agree, and the design team can adhere to any cost estimates that accurately reflect that agreed upon scope. Between cost estimate submissions, continuing budget checks and ongoing value engineering, we will keep the design goals aligned with the budget. Our extensive database of information from previous completed projects allows the team to make meaningful and informed decisions regarding design solutions that stay within budget and keep the project on schedule.

Our first line of defense for reducing construction phase change orders is our commitment to the highest level of design and detail in our construction documents, accurately representing the vision for the project, and incorporating State of West Virginia purchasing regulations into that documentation. Alternates are presented to the client with an "apples to apples" list of pros and cons, including cost benefit and life cycle analysis. This allows for intentional decisions to be made by the entire team.

Our approach to meeting Goal 3, producing multiple bid packages and administering phased construction, is similar to how we have planned and implemented many previous projects. Much of our renovation work within large public performance venues, museums, libraries, and public-facing office spaces has required multiple construction documents and bid packages, as well as phasing plans to maintain continuous operations within the facility.

We have successfully planned projects to meet aggressive schedules, such as the **Eisenhower and Terrace Theaters at the Kennedy Center**, both of which were tightly planned to meet their opening performances. This involves plans that provide temporary access and public wayfinding and/or mechanical systems to enable continued operation during construction, as was the case for the **National Museum of Natural History's Sant Ocean Hall**. The phasing plan for the multi-year **National Air and Space Museum** project addressed a complex sequenced construction while the museum remained open to the public.

We believe that successful phased projects involving existing buildings begin with intelligent planning and a clear understanding of the Owner's operations, as well as funding availability. We will work hand in hand with the West Virginia Department of Tourism to develop project phasing that meets those parameters.





Goal/Objective 4: Construction in Occupied Spaces

As building renovation experts, QE has implemented dozens of major renovations and comprehensive modernization projects in occupied buildings. Many of these projects have involved very large public buildings with extremely challenging phasing and operational requirements, for example, the **National Museum of Natural History**, the **National Air and Space Museum**, and the **John F. Kennedy Center for the Performing Arts**. Others have been complex, multi-occupant, and multi-use buildings like the **Milwaukee Federal Building** and **US Courthouse**, and the **Ann Arbor Municipal Center**.

Construction in occupied buildings while maintaining operations begins with intelligent planning. We ensure that phasing or sequencing is incorporated into the process, schedule, and cost estimation from the outset. Where necessary, we produce separate phasing drawings that include fire egress, sound and dust protection, as well as support services design.

Keeping building systems operational is also an absolute requirement. For many projects, operating existing and replacement systems side-by-side for a

period of time is necessary. For some, installation of temporary equipment is required, particularly when existing and new systems must be housed in the same mechanical or electrical rooms. For this reason, we look for opportunities to install new systems in newly created spaces.

Safety and comfort for building occupants come first. The best way to protect occupants and the public is to keep them at a distance from construction, and the best way to provide distance is to plan construction phases in areas separated from occupied spaces. When sufficient distance is not possible, separation must be achieved through alternative methods, such as providing temporary protection, segregated egress paths, scheduling off-hours work, and other noise control measures.

Another phasing concept we strive to achieve is a “move once” strategy. Particularly useful in partially occupied buildings, the renovation of spaces is sequenced so that current occupants can move permanently into newly renovated spaces, and the spaces they vacate are renovated for new occupants. Sometimes, this takes the form of several small projects being completed before the “main” project is commenced.

Goal/Objective 5: Working in compliance with the State Purchasing Regulations

Silling brings multiple decades of experience delivering projects throughout West Virginia, each incorporating the State's purchasing regulations and Supplementary Conditions to AIA Documents A201 and B101. Our history, dating back to the early to mid-1990s, reflects a portfolio totaling over **1.5 million square feet** of completed projects with a combined **construction value exceeding \$250 million**. This experience includes providing professional services to prominent state agencies such as the **West Virginia General Services Division**, the **West Virginia Division of Corrections**, the **West Virginia Supreme Court of Appeals**, and the **West Virginia Lottery Headquarters**. Our team's familiarity with these requirements ensures that construction administration aligns with statutory standards and best practices. This depth of experience allows us to confidently guide projects from design through completion while maintaining compliance and promoting efficiency.

We devote significant time and effort to thoughtful, research-based product selection to ensure our specifications promote fairness and competition. For every product category, we include a minimum of three manufacturers whenever possible—unless no other manufacturer exists—so that bidders have multiple options. This approach benefits the competitive bidding process by preventing favoritism toward any single brand, broadening market participation, and driving cost efficiency without compromising quality. By fostering a level playing field, we help owners achieve the best value while maintaining compliance with state purchasing guidelines.

Silling is widely recognized for producing clear, concise, and well-coordinated construction documents that streamline the bidding process and result in accurate bid numbers while minimizing ambiguity during construction. This level of precision reduces the potential for misunderstandings and ensures that contractors can confidently prepare competitive bids. Our project history demonstrates a consistent track record of avoiding construction change orders and cost overruns, reflecting the quality and completeness of our documents. This continued performance is further evidenced by a

staggering list of repeat clients and a proud history without any errors and omissions claims against our professional liability coverage—an achievement that underscores our commitment to excellence and reliability.

Our approach to construction contract administration is to be a collaborative partner, never as an adversary. We act as the Owner's eyes and ears throughout the construction process, diligently ensuring quality workmanship and strict compliance with the construction documents. Our team performs bi-weekly site visits—unless the Owner requests more frequent visits—to monitor progress and address issues proactively. We actively participate in pre-installation conferences and review mock-ups to confirm that design intent and performance standards are met. Throughout construction, we pride ourselves on issuing timely corrective action lists and maintaining responsiveness to time-sensitive questions and submittal reviews. This hands-on, team-oriented approach fosters trust, minimizes delays, and ensures successful project delivery.



Project Experience





West Virginia Culture Center

Charleston, West Virginia

Project Details

180,000 sf new construction

Opened on July 11, 1976 with \$14 million construction cost

30,000 visitors on opening day

"The building exists to incorporate the vitality of West Virginia. The Science and Culture Center is - and will be - very much alive with the energy of West Virginia."
Governor Arch Moore

Client

State of West Virginia

Project Relevancies

- Designed by Silling in 1972
- Currently collaborating with WDP for front window evaluation
- Extensive knowledge of building plans and details
- Firm "legacy" project that displays our value in West Virginia public buildings

Designed to showcase the Mountain State's artistic, cultural, and historic heritage, architect C.E. "Cy" Silling described "the theme of the building in plan and design, exterior and interior, as a quiet, classic expression of West Virginia at its best."

In 1976, the Cultural Center became the home of the new West Virginia Division of Culture and History, including its arts and historic preservation units, the State Archives, the Norman L. Fagan State Theater, State Museum, and the State Museum Shop. The West Virginia Library Commission shared the building, with its offices and a major library there as well. The Center's great hall, with its white Alabama marble walls accented by West Virginia oak, a red Tennessee marble floor, gold and wood coffered ceiling, and two large dodecahedron-shaped bronze and crystal chandeliers, welcomes visitors. The 468-seat theater, behind the great hall, hosts West Virginia's performing artists, dance, theater, jazz, and film festivals, affairs of state, and performance broadcasts of West Virginia Public Broadcasting's "Mountain Stage."





National Air and Space Museum

Smithsonian Institution | Washington, DC

Project Details

Major revitalization of an historic museum situated on the National Mall

687,000 sf

Phased construction

Client Contact

Smithsonian Institution

Charles Obi, RA, LEED AP,
Project Manager, Office
of Planning Design &
Construction

obic@si.edu

202.633.6271

Project Relevancies

- Work began with assessment to document repair recommendations
- Included development of competitive design and construction documents including construction administration. Multi-disciplinary consultant coordination was required.
- Phased Construction involving multiple bid packages
- Occupied Project Site
- Complied with AIA General Conditions

A phased renovation of this late Modernist structure is renewing the Smithsonian's most-visited museum on the National Mall, creating exciting new dynamic learning experiences for audiences of all ages and types.

The Smithsonian Institution initially defined the project by the need to address building envelope improvements (repair and/or replacement) as well as the replacement of mechanical systems that had reached the end of their service life.

After nearly four decades of use, the museum's stone façade had begun to deteriorate past the point of repair. The 1-1/4 inch limestone panels had warped and cracked, and were too thin to withstand further weathering. The project began with the development of an Exterior Envelope Study and a Sustainability Study. The study of the envelope included testing of the existing stone cladding system and carefully considered repair and replacement options relative to performance, as well conformance with the original design intent and aesthetic of the façade.

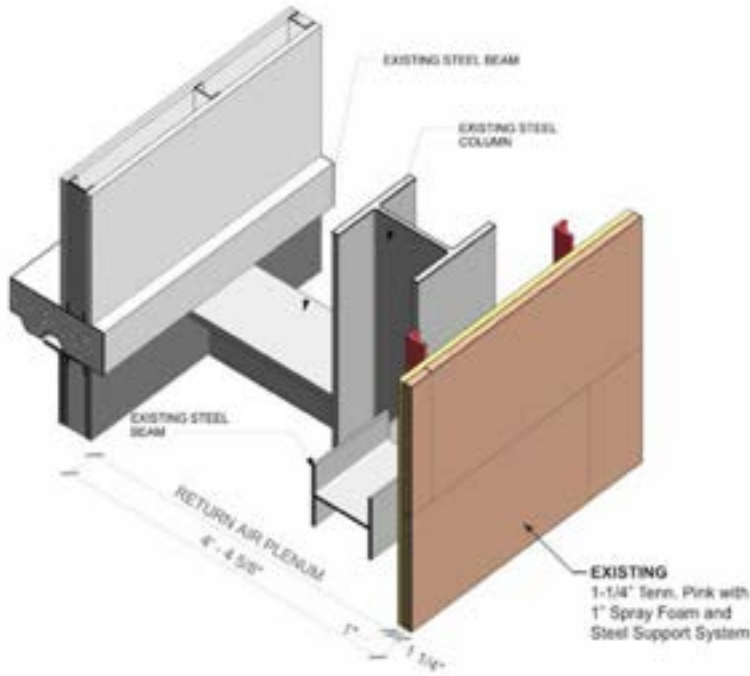

EXISTING WALL ASSEMBLY

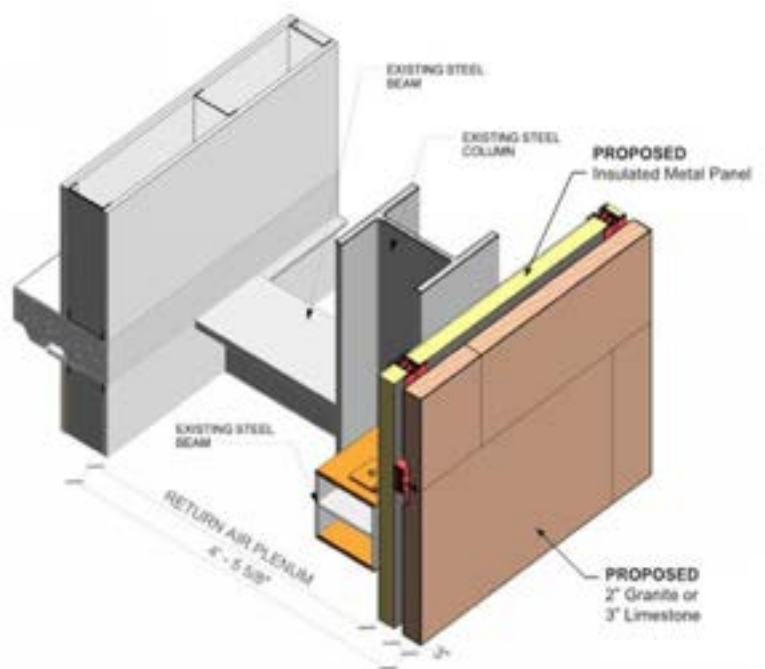

PROPOSED ASSEMBLY

In addition, the museum's outdated mechanical system required replacement. The QE team generated high-performance envelope solutions, using such advanced technologies as stone testing, water and air leakage testing, hygro-thermal analysis (WUFI), computational fluid dynamics (CFD), and energy modeling, allowing a comprehensive analysis to predict energy, lighting, ventilation, thermal, and moisture performance in the modernized structure.

NASM was originally designed by Gyo Obata of HOK and opened on July 1, 1976, for America's Bicentennial. As extensive building envelope and systems work will have a significant impact on both the exterior and interior of the museum, one of the design team's guiding principles was to respect and maintain Obata's original design intent and the character-defining features of the museum. This approach was critical both for the replacement the building envelope and for the extensive

systems work, which had impact on both the exterior and interior of the museum. Design solutions including the complete replacement of the museum's stone cladding were informed by extensive study and analysis, several rounds of mock-ups and consultation with review agencies.

The QE team worked closely with regulatory agencies and Smithsonian leadership with the goal of creating synergies between the building's exterior and engineering and infrastructure systems that result in significant energy savings and transform the museum into a more high performance building (achieving LEED v4 Gold certification).

The exterior stone cladding and expansive glazing have been replaced, tightening the building envelope, significantly improving daylighting conditions and reducing ongoing energy usage.



Cabarrus County Courthouse

Concord, North Carolina

Project Details

72,000 sf renovation
240,000 sf expansion
Building envelope
improvements

Client

Cabarrus County, NC
Kyle Bilafer, Assistant
County Manager
kdbilafer@
cabarruscounty.org
704.920.3201

Recognition

AIA WV Merit Award for
Achievement in
Architecture
North Carolina Main
Street Award of Merit for
Best Public Building
Improvement

Project Relevancies

- Preservation and transformation of iconic, mid-century civic building
- Multiple Construction Phase packages
- Building envelope improvements & modernization
- Under budget construction delivery in post-pandemic market volatility

The Cabarrus County Courthouse project brings a significant new addition to the courthouse campus while connecting to and renovating the existing 1975 structure to deliver a relevant and contextually sensitive place for justice and civic engagement within Concord's charming downtown district.

With great sensitivity to the scale and character of the intimate, eclectic urban fabric, the expansive programmatic needs of the Cabarrus County Courthouse project are carefully woven into its immediate context – completing the infill of its civic block with an intentional delicacy toward both its users and the public realm. Through study of the physical and cultural context of the community it serves, the design concept speaks to the rich heritage of art, celebration, and craft--synonymous with the legacy of the textile industry--the social and economic foundation of the region. The new courthouse addition acknowledges the scale, rhythms, and texture of the immediate courthouse campus and surrounding district while appropriately marking its place in the context of time.





National Academy of Sciences

Washington, DC

Project Details

164,430 sf renovation

9,540 sf addition

Original building dates to 1924 (Bertram Goodhue); additions in 1962, 1965, 1970

Historic building

Local Agency Review/Approval

Accessibility/ADA/universal design improvements

Systems replacement

Historic auditorium restoration

Client

National Academy of Sciences

Joe Papa, Former Director of Facilities Management

jpapa944@gmail.com

202.236.0421

Project Relevancies

- Work began with assessment to document repair recommendations
- Included development of competitive design and construction documents including construction administration. Multi-disciplinary consultant coordination was required.
- Phased Construction involving multiple bid packages
- Complied with AIA General Conditions

Balancing both Neoclassical and Mid-Century Modern aesthetics, the renovation of the acclaimed National Academy of Sciences headquarters restores the landmark building with a meticulous conservation approach and introduces cutting-edge sustainable strategies.

Among the few privately owned buildings to grace the National Mall, the National Academy of Sciences (NAS) headquarters features the grandeur of Bertram Goodhue's ornate structure from circa 1924 combined with AIA Gold Medalist Wallace Harrison's bold, 1960s-era additions. The headquarters, listed on the National Register of Historic Places, was in dire need of renewal, with worn finishes, dated building systems, and a deteriorating building envelope. The compromised floor plate also limited circulation, functionality, and accessibility.



Leading a multidisciplinary design and conservation team, we preserved and restored the building's monumental "Great Hall," which features a 56-foot-high painted dome and art-filled galleries, auditorium, offices, and meeting spaces. Without substantially altering the building's footprint, we doubled the amount of first-floor meeting and support space by enclosing three courtyards to create new, climate-controlled spaces for pre-function use, display, dining, and meetings. Challenges ranged from the restoration of the original paintings, murals, sculptures, and decorative motifs to incorporating sustainable technology, including building-integrated photovoltaics within the skylights. We restored the main axis extending from Constitution Avenue in alignment with Goodhue's vision and reopened the original south portal at the main entrance. The building, a popular venue for lectures, concerts, and conferences, now serves as a fitting showcase for "America's Temple of Science."





Kanawha County Public Library

Charleston, West Virginia

Project Details

60,000 sf renovation
20,000 sf expansion

Client

The Library Foundation of Kanawha County, LLC

Tom Heywood,
Past President

theywood@bowlesrice.com

304.347.1702

Recognition

AIA WV Honor Award for
Excellence in
Architecture

AIA WV Honor Award for
Excellence in
Craftsmanship

AIA Cleveland Honor
Award

Project Relevancies

- Historic Preservation
- Historic building renovations & modernization
- Project collaboration with Partner Architect
- Under budget construction delivery in post-pandemic market volatility

Through the reimagined project, the Kanawha County Public Library revives a landmark in downtown Charleston and brings a vibrant, animated space to serve as the community's living/learning room.

The project direction for the re-imagination of the KCPL was focused equally on programmatic relevance and architectural transformation. Rethinking library services most valuable to an historic downtown, its residents, businesses, and visitors, the project required a significant increase in space – providing more opportunities for people to meet and engage. A new addition, architecturally marking its place in time through crisp, modern design and detailing, physically embraces the iconic, century-old classical structure.

Additional improvements included a new pedestrian bridge connection to a public parking garage, large and small meeting and study rooms, a café, maker space, and outdoor public gardens and plazas for both programmed and spontaneous use.

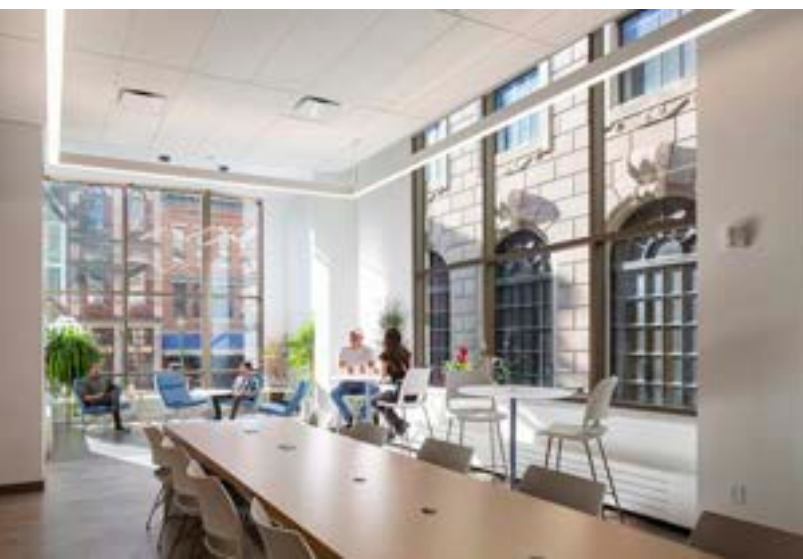
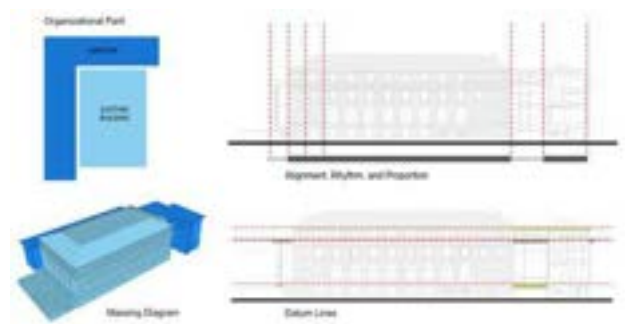



John F. Kennedy Center For The Performing Arts

Washington, DC

Project Details

1.5 million sf renovation

Local Agency Review/
Approval

Accessibility/ADA/universal
design improvements

Systems replacement

Historic auditorium
restoration

Theater building constructed
in 1971; designed by Edward
Durrell Stone

Renovations of multiple
theater venues

Building occupied and
operational during
construction

High-Profile stakeholder
engagement

Client

John F. Kennedy Center for
the Performing Arts

Betty Siegel, Program
Manager Accessibility
Education

BSiegel@Kennedy-Center.
org

202.437.1503

Project Relevancies

- Work began with assessment to document repair recommendations
- Included development of competitive design and construction documents including construction administration. Multi-disciplinary consultant coordination was required.
- Phased Construction involving multiple bid packages
- Occupied Project Site
- Complied with AIA General Conditions

QE has implemented the phased sequential implementation of capital projects for each of the Kennedy Center's four main venues as defined in the master plan.

The work entails over \$100 million of construction. In addition to the individual projects summarized below, we have developed a Comprehensive Building Plan, performed life safety and accessibility upgrades, and created a Facilities Management Database for the 1.5 million-sf building. The Kennedy Center remained operational and open to the public during all of QE's renovation work at this iconic venue.

Concert Hall. QE's award-winning renovation of the 2,465-seat home of the National Symphony Orchestra was a technically complex project that provided universal access within the Hall at all seating levels, improved acoustic performance, and addressed life safety issues, while also dramatically changing the original monochromatic color scheme to create a rich and warm space.



Opera House. Our work within the 2,364-seat Opera House provided a renewed performance venue while retaining the contextual design of this iconic space, home to the Washington National Opera. The renovation included substantial reworking of the auditorium, replacement of the orchestra level floor, relocation of the rear auditorium wall at the orchestra and box tier levels, and new architectural lighting.

Eisenhower Theater. The 1,164-seat Eisenhower Theater renovation creates a completely new and sophisticated 1,164-seat theatrical space that enhances the intimacy of the Kennedy Center's drama venue, while optimizing the theater experience for audience and performers alike.

Terrace Theater. The Terrace Theater is a 490-seat venue that serves as the Kennedy Center's home for chamber music and jazz, as well as wide variety of dance and theater programming. Our renovation completely transformed the space to provide accessible seating distributed at all levels and a new look for the theater and lobby.

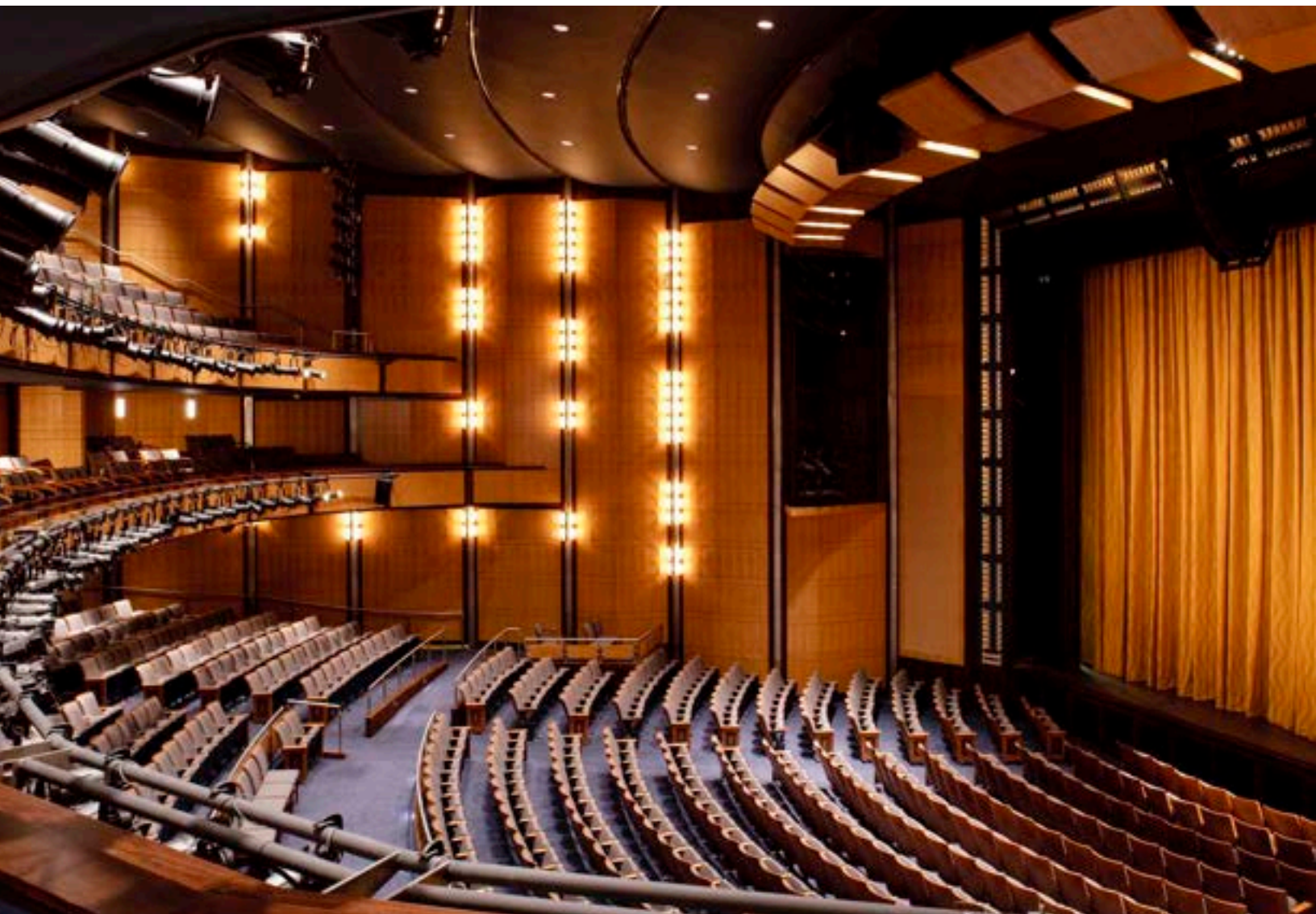

The practical lessons and experiences that we have gained from that work are a resource and directly applicable to the renovation of JFKLF's theaters. Each of the theater renovations had modest budgets for the amount of work. In all cases, the renovated halls were praised for both public accommodation and technical improvements.



Concert Hall | 1997

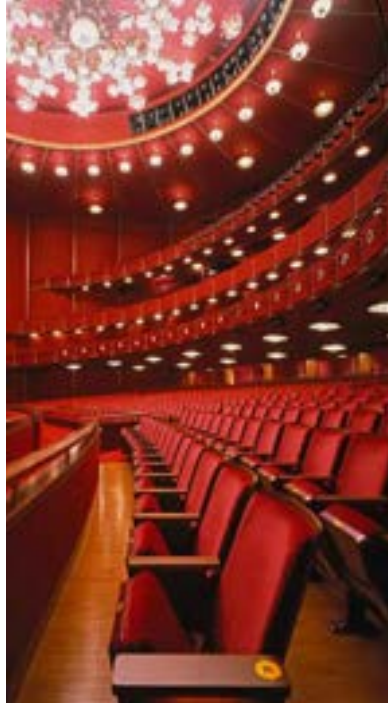

Opera House | 2003



Eisenhower Theater | 2008

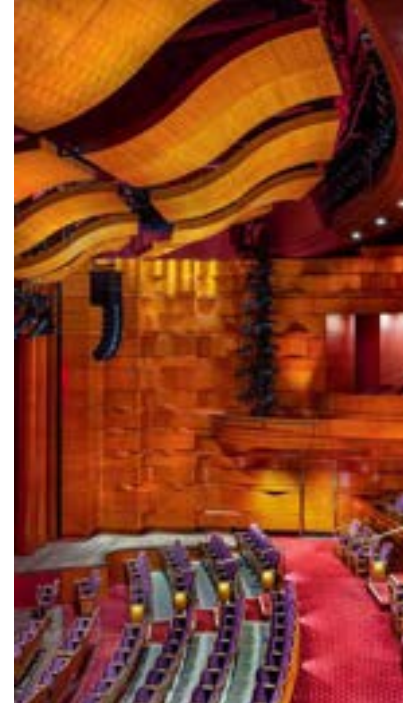

Terrace Theater | 2017

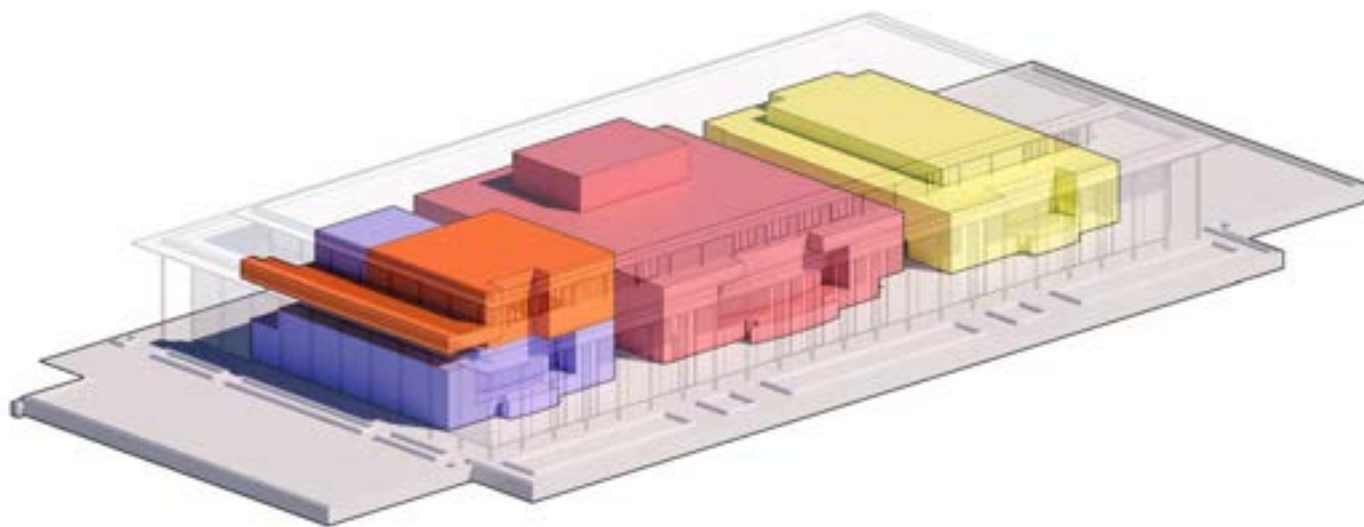
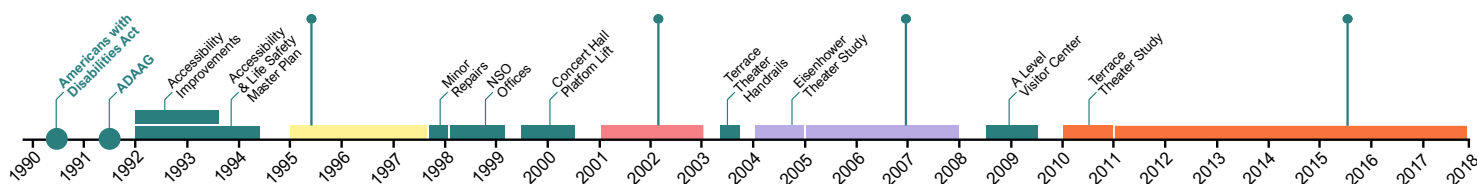

“For the disabled, the new Concert Hall is a marvel: You go in on your own, you go out on your own; no one to ask, no one to thank. Nothing to do but, like everyone else, enjoy.”

Charles Krauthammer, Washington Post Columnist and Wheelchair User

Accessibility

Driven by the legacy of President Kennedy, the Center’s commitment to become a national role model for accessibility and inclusion in the performing arts for patrons, performers, and staff alike inspired each design. As a result of QE’s work, the Kennedy Center is now widely recognized as the national leader in accessibility for the performing arts, receiving the prestigious Paralyzed Veterans of America’s Barrier-Free America Award in 2022. QE’s work has given the Center the platform from which it serves as a powerful advocate and resource for accessibility for arts organizations across the nation and worldwide. Each of these theater renovations seamlessly integrated more than twice the required number of accessible seats distributed at every level of each theater. Each of the renovations also provided accessible back of house amenities, including dressing rooms.



National Society of the Daughters of the American Revolution

Washington, DC

Project Details

3,700 seat auditorium

267,000 gsf

National Historic Landmark

Accessibility/ADA/
universal design
improvements

Systems replacement

Historic auditorium
restoration

Local Agency Review/
Approval

High-Profile stakeholder
engagement

Client Contact

National Society of the
Daughters of the
American Revolution

Paul Guilderson,
Managing Director
pguilderson@dar.org
202.879.3347

Project Relevancies

- Work began with assessment to document repair recommendations
- Included development of competitive design and construction documents including construction administration. Multi-disciplinary consultant coordination was required.
- Phased Construction involving multiple bid packages
- Occupied Project Site
- Complied with AIA General Conditions

Quinn Evans has provided architectural services for multiple restoration projects at this historic national headquarters.

The three buildings that comprise the headquarters— Memorial Continental Hall, Constitution Hall, and the Administration Building—are housed on a full city block in downtown Washington, DC. Preserved as National Historic Landmarks, these buildings have hosted historic and cultural events for over a century. The buildings have remained fully functional and occupied during all of QE's work.

A comprehensive restoration and rehabilitation of Constitution Hall, a 3,700-seat auditorium, was completed in a three-phase modernization. The latest phase renovated the auditorium's flooring, ceiling, acoustics, seating, dressing rooms, restrooms, decorative elements, and color scheme. The project also improved production capabilities, safety, and accessibility. Key challenges included replicating the original laylight, introducing new rigging infrastructure, and conserving artistic elements. The transformation also included restoration and renovation of the Hall's lobby, reception room, attic, and back-of-house spaces.

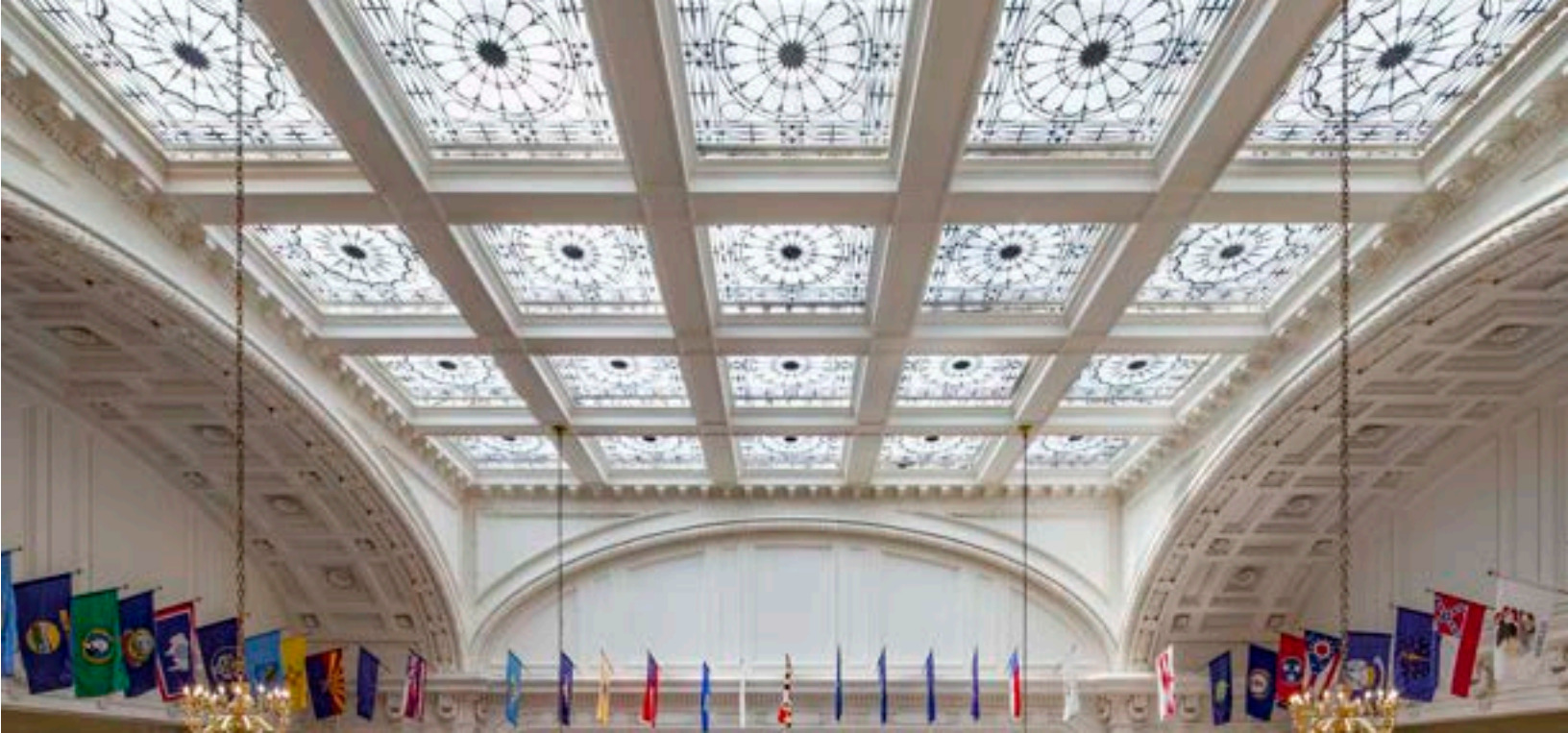

Exterior projects have included repair and cleaning of limestone and marble facades and window painting. Within Memorial Hall, the original meeting location of the annual Congress, the firm led the meticulous conservation and restoration of a leaded-glass skylight. Historic interiors renovations have renewed the President General's Reception Room and the lobbies of Constitution Hall.





Architect of the Capitol IDIQ

Washington, DC

Project Details

Utility infrastructure improvements

Renovation work in occupied buildings

Restoration/rehabilitation of historical structures

Listed in the National Register of Historic Places

Client Contact

United States Capitol

Dan Alexander, Project Manager

dan.alexander@aoc.gov
202.228.1793

Project Relevancies

- Work began with assessment to document repair recommendations
- Included development of competitive design and construction documents including construction administration. Multi-disciplinary consultant coordination was required.
- Phased Construction involving multiple bid packages
- Occupied Project Site
- Complied with AIA General Conditions

Since 2014, back-to-back architectural and engineering IDIQ contracts with the Architect of the Capitol (AOC) have resulted in over 40 projects at some of the most historic and iconic buildings in the Nation's Capital. Our current contract is renewed through 2032.

Quinn Evans has successfully managed a multidisciplinary team of dozens of subconsultants to deliver a variety of projects to upgrade AOC facilities, including the Library of Congress' Thomas Jefferson Building (1897) and the Supreme Court Building (1935), as well as late Modern structures such as the James Madison Memorial Building (1980) and Hart Senate Office Building (1982). Similar to the task orders anticipated as part of the DC Courts IDIQ, projects have ranged from security upgrades to master planning and historic preservation work. Below are selected projects from among the more than 40 we have completed for AOC.

Longworth House Office Building Masonry Envelope

and Roof Repair. QE is leading the restoration and renovation of the Longworth House Office Building's roof and building envelope. The project includes repairs and partial replacement of metal roofs, full replacement of non-metal roofs, fall protection system modifications, new snow guards, and lightning protection system repairs and recertification. The building envelope work involved surveying current conditions and developing a complete design package for cleaning, repairing, and restoring the exterior stone façade, including doors, windows, and decorative metals

Dirksen Senate Office Building Roof Replacement. QE completed design services for the Dirksen Senate Office Building's 3,000 sf south moat roof replacement. The project involved a comprehensive survey and construction document development for a 1972 copper-roofed area, addressing complex water infiltration issues around roof drain penetrations and perimeter intersections, while preserving the building's historic character.



US Capitol Building



A sampling of our additional task order projects includes:

- United States Capitol Fire Protection IDIQ
- Thomas Jefferson Building Roof Repair
- Madison Building Upper Roof Replacement
- Library of Congress John Adams Building Exterior Restoration
- Thurgood Marshall Federal Judiciary Building Facade
- Thurgood Marshall Federal Judiciary Building Director's Suite
- House Office Building Conveyance

Russell Senate Office Building





Heritage Hall

Michigan State Capitol | Lansing, Michigan

Project Details

38,500 sf

300-seat multipurpose space

Local Agency Review/
Approval

Accessibility/ADA/
universal design

Systems coordination

High-Profile stakeholder
engagement

Client

Michigan State Capitol
Commission

Rob Blackshaw, Director
of Facility Operations

rblackshaw@legislature.
mi.gov

517.373.2099

Recognition

2024 Large Building
Award, AIA Huron Valley

Project Relevancies

- Included development of competitive design and construction documents including construction administration. Multi-disciplinary consultant coordination was required.
- Occupied Project Site
- Complied with AIA General Conditions

The underground expansion at the Michigan State Capitol introduces exciting and educational opportunities for visitors within the historic facility's context.

The QE team leveraged our deep knowledge of the 1878 Capitol from previous projects, which included both interior and exterior rehabilitations. Our design for Heritage Hall places the two-level visitor facility largely below grade, minimizing disruption to the historic landscape. Dramatic views up to the Capitol through expansive skylights link heritage and history, balancing the relationship between the historic building and the expansion. The design encompasses a new entrance from the Capitol lawn into the underground expansion and provisions for bus arrivals for schools and large groups from an adjacent parking area.

The Heritage Hall program offers the Capitol expanded educational opportunities, additional interpretive features, and spaces for special events. Flexible multipurpose and meeting spaces support a variety of functions to support long-term use and stewardship. A multi-function divisible meeting space is surrounded by orientation and gathering areas as well as gracious, accessible connections to the Capitol complex.

QE guided the delivery team with keen and integrated attention to a wide range of issues associated with high-visitorship public facilities. The prominent and historic context of the Capitol building required expertise and the utmost care and sensitivity. The design was subject to jurisdictional historic review and approvals. It was critical that the Hall's program spaces stand the test of time with built-in adaptability for change. It was imperative that the below-grade portions of the structure provide a robust envelope and redundant waterproofing in addition to the featured connections between major spaces and the historic Capitol.



"You [QE] really listened to what we needed. You introduced a program that illustrated a modern-day visitor center that encompassed all the functions we were looking for. Your creativity and visualization led this to become a successful project."

*Rob Blackshaw,
Director of Facility Operations*



Cost Conscious Design

QE worked with the owner very early in programming to make some difficult decisions on programmatic elements and impact on budget. QE presented the budgetary and practical value to the overall project viability by removing this single function areas so that the project was able to move forward into Schematic Design. The invaluable impact of having difficult, honest, and necessary conversations early kept project goals at the forefront of decision-making, enabling the delivery of high-value solutions and allowing the project to stay on schedule and viable.



Old City Hall

Richmond, Virginia

Project Details

118,000 sf revitalization of exterior envelope and interior finishes

National Historic Landmark

National Register of Historic Places

Contemporary intervention

Below-grade waterproofing

Local Agency Review/Approval

Accessibility/ADA/universal design improvements

Systems replacement

Client

Commonwealth of Virginia

Erich Thomas, Former Capital Outlay Manager (now at Virginia Commonwealth University)

thomasea5@vcu.edu

804.659.3012

Project Relevancies

- Work began with assessment to document repair recommendations
- Included development of competitive design and construction documents including construction administration. Multi-disciplinary consultant coordination was required.
- Phased Construction involving multiple bid packages
- Occupied Project Site
- Complied with AIA General Conditions

An ambitious renovation of Richmond's iconic Old City Hall preserves a Capitol Square landmark and creates reimaged space for multiple state government agencies.

Designed by Elijah E. Myers, Old City Hall has been an enduring presence in the heart of downtown Richmond since its completion in 1894. The three-story building, which spans an entire block, is the largest building constructed of granite in the City. Old City Hall features a prominent silhouette with two large towers and extensive ornamentation along the stone façade. Inside, a full-height central court echoes European architectural tradition with elegant, locally crafted cast iron stairs, elaborately detailed columns, and arcaded galleries.

The renovation of this grand building included extensive measures to address water damage and restore the exterior envelope. Our team surveyed the masonry walls and specified rehabilitation measures, including full repointing of the granite, cleaning, and repairs that included the use of Dutchman and patching mortar. We also designed the roof replacement and window restorations. We designed the project in accordance with the Secretary of the Interior's standards, creating a modern workspace to suit a host of state agencies.



References



Quinn Evans



Betty Siegel, Program Manager, Accessibility Education
202.437.1503 | bsiegel@kennedy-center.org
John F. Kennedy Center for the Performing Arts

Silling



Tom Heywood, Past President
304.347.1702 | theywood@bowlesrice.com
The Library Foundation of Kanawha County

Quinn Evans



**Charles Obi, RA, LEED AP,
Project Manager**
202.633.6271 | obic@si.edu
*Smithsonian Institution,
National Air & Space Museum*

Quinn Evans

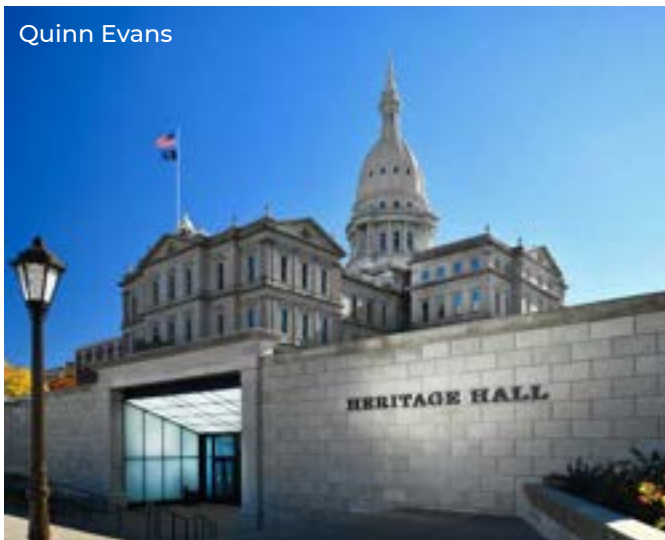

**Rob Blackshaw, Director of
Facility Operations**
517.373.2099 | rblackshaw@legislature.mi.gov
Michigan State Capitol, Heritage Hall

Silling



Kyle Bilafer, Assistant County Manager
704.920.3201 | kdbilafer@cabarruscounty.us
Cabarrus County Government

QUINN
EVANS

SILLING